

9th International Carbon Dioxide Conference

3-7 June, 2013





Beijing, China

<http://icdc9.lasg.ac.cn>



Sponsors

ICDC9 extends its appreciation to the following sponsors for their invaluable commitment and support:

-  Chinese Academy of Sciences(CAS);
-  National Natural-Science Foundation of China(NSFC);
-  Institute of Atmospheric Physics (IAP), CAS;
-  State Key Laboratory of Numerical Modelling for Atmospheric Sciences and Geophysical Fluid Dynamics (LASG), IAP, CAS
-  Chinese-American Oceanic and Atmospheric International Training and Education Center (COAA ITEC)

Advances in Atmospheric Sciences (AAS)

ISSN 0256-1530/CN 11-1925/O4

Bimonthly

Launched in 1984

2011 Impact Factor (Journal Citation Reports): 0.987

Sponsored by the Chinese National Committee for International Association of Meteorology and Atmospheric Sciences (IAMAS) and the Institute of Atmospheric Physics, Chinese Academy of Sciences (IAP/CAS)

Editors-in-Chief: Daren LÜ, Huijun WANG, and Ming XUE

Co-published by Science Press and Springer

Email: aas@mail.iap.ac.cn

<http://www.iapjournals.ac.cn/aas>



AAS is an international journal on the dynamics, physics, and chemistry of the atmosphere and oceans. It covers the latest achievements and developments in the atmospheric sciences, including marine meteorology and geophysics, as well as theoretical and applied areas of these disciplines. In 2008, ScienceWatch.com named AAS as a "rising star" in the geosciences journals. In 2009, AAS was included in SCI. Springer Market Intelligence & Web Analytics 2012 showed that in 2012 there were 26,547 full-text article downloadings from the Springer website.

Abstracted and indexed by:

Science Citation Index; Meteorological & Geostrophysical Abstracts; CAB Abstracts; Chinese Journals Full-Text Database/Science-Engineering (A); WanFang Data/ Fundamental Sciences/Geosciences; and VIP Information/Chinese Scientific Journals Database



Atmospheric and Oceanic Science Letters (AOSL)

Editors-in-Chief: Hui-Jun WANG and Ola M. JOHANNESSEN

Bimonthly

Launched in 2008

CN 11-5693/P

ISSN 1674-2834

Tel: 86-10-82995273/5203

Fax: 86-10-82995053

Email: aosl@mail.iap.ac.cn

Journal scope

AOSL is an international journal for the publication (in English) of original Letters related to all aspects of the atmospheric sciences and physical oceanography. The journal provides a rigorous peer-review process, rapid publication speeds (final decision in three months, and publication in six months), and maintains high standards in the quality of accepted manuscripts.

Abstracted and indexed by:

CNKI and WanFang Database

Websites

- Online manuscript platform: <http://mc03.manuscriptcentral.com/aosl>
- Free access: <http://www.iapjournals.ac.cn/aosl>

CONTENTS

COMMITTEES	1
GENERAL INFORMATION	3
PLENARY PROGRAM	5
PARALLEL PROGRAM	9
POSTER LISTING	12
EXHIBITION	21
LIST OF PARTICIPANTS	23



9th International Carbon Dioxide Conference
3-7 June 2013, Beijing, China

COMMITTEES

Conference Chair

Ning Zeng, University of Maryland, USA and Chinese Academy of Sciences

Scientific Steering Committee

- Laurent Bopp, LSCE, France
- Wei-Jun Cai, University Delaware, USA
- Ken Caldeira, Carnegie Institution for Science, Stanford, USA
- Pep Canadell, Global Carbon Project, CSIRO, Canberra, Australia
- Jing Chen, University of Toronto, Canada and Nanjing University, China
- Phillipe Ciais, LSCE, Gif-sur-Yvette, France
- Ken Davis, The Pennsylvania State University, University Park, USA
- Jingyun Fang, Peking Univ., China
- Niki Gruber, ETH Zürich, Switzerland
- Martin Heimann, Max-Planck-Institute for Biogeochemistry, Jena, Germany
- Nianzhi Jiao, Xiamen University, China
- Michio Kawamiya, JAMSTEC, Japan
- Corinne Le Quéré, Tyndall Centre for Climate Change Research, University of East Anglia, UK
- Hong Liao, IAP, Chinese Academy of Sciences, China
- Daren Lu, Institute of Atmospheric Physics, CAS
- Yiqi Luo, University of Oklahoma, USA
- Gregg Marland, Appalachian State University and Oak Ridge National Lab, USA
- Anna Michalak, Carnegie Institution for Science, USA
- Peter Raymond, Yale University, USA
- Stephen Sitch, University of Exeter, UK
- Pieter Tans, ESRL, USA
- Riccardo Valentini, University of Tuscia, Viterbo, Italy
- Ye Qi, Tsinghua University, Beijing, China
- Richard Zeebe, University of Hawaii, USA
- Ning Zeng, University of Maryland, USA (Conference Chair)

Local Organizing Committee

Chair: Huijun Wang, Institute of Atmospheric Physics, CAS

Vice Chairs: Zhenghui Xie and Hong Liao, Institute of Atmospheric Physics, CAS

Members:

- Zhengtang Guo, Institute of Geology and Geophysics, CAS
- Yao Huang, Institute of Botany, CAS
- Zengyuan Li, Chinese Academy of Forestry
- Guanghui Lin, Tsinghua Univ.
- Riyu Lu, Institute of Atmospheric Physics, CAS
- Shilong Piao, Peking University
- Yude Pan
- Xiaobo Ren, Chinese Academy of Sciences
- Changqing Song, NSFC
- Pinxian Wang, Tongji Univ.
- Shaoqiang Wang, Institute of Geographic Sciences and Natural Resources Research, CAS
- Guirui Yu, Institute of Geographic Sciences and Natural Resources Research, CAS
- Chaolin Zhang, NSFC
- Lu Zhang, Institute of Atmospheric Physics, CAS
- Guangsheng Zhou, China Meteorological Administration
- Lingxi Zhou, China Meteorological Administration

Secretary General:

Zhenghui Xie, Institute of Atmospheric Physics, CAS

Secretariat:

Ms. Jenny Lin, mobile phone: 86+13671063035, secretariat@lasg.iap.ac.cn

Ms. Tracy Jin, mobile phone: 86+13810930802, lasg@lasg.iap.ac.cn

Ms. Jiaxin Han

Ms. Chen Chen

Mr. Kangjun Chen (technical support)

State Key Laboratory of Numerical Modelling for Atmospheric Sciences and Geophysical Fluid Dynamics (LASG), Institute of Atmospheric Physics, Chinese Academy of Sciences
No. 40 Huayanli, Beichen West Road, Chaoyang District, Beijing, 100029, China

GENERAL INFORMATION

Venue

Beijing International Convention Center (BICC)
Add: No.8 Beichen Dong Road, Chaoyang
District, Beijing, P. R. China 100101
Website: www.bicc.com.cn

A map of BICC and its neighborhood including location of hotels can be found at the back of this handbook.

Registration

The registration desk is located in the Ground Floor Foyer of the BICC, right next to the Plenary Hall (Hall 3) and Exhibition Hall (Hall 4) and will be open at the following times:

Saturday 1 June 2013	1700 - 1900
Sunday 2 June 2013	0730 - 2000
Monday 3 June 2013	0730 - 1000

Presentation Preparation

Presenters must upload presentations during coffee breaks before, preferably one day prior to the start of their session to ensure their presentations are loaded successfully.
Poster presenters must put up the posters on Sunday 2 June or in the morning of 3 June. They may leave their posters with secretariat.

Registration Entitlements:

For general participants the registration fee entitles you to the following:

- ✦ attendance to all scientific sessions;
- ✦ admission to the exhibitions;
- ✦ Icebreaker on 2 June and banquet on 3 June;
- ✦ coffee breaks and lunches on weekdays;
- ✦ a hard copy and a memory stick of the meeting program and the abstract volume;
- ✦ a city tour on the afternoon of 5 June.

Accompanying persons officially registered through the conference website are entitled to the following:

- ✦ Icebreaker on 2 June and banquet on 3 June;
- ✦ a city tour on the afternoon of 5 June

Please note: Registration fee cannot be returned if participants choose not to attend some of the activities mentioned above.

ICDC9 volunteers will be at the podium and the secretariat desk to assist you.

Internet- wireless

All delegates have access to the BICC free wireless Internet service. To connect to this free service, choose the wireless network called "CMCC-GJHY" from the wireless networks list.

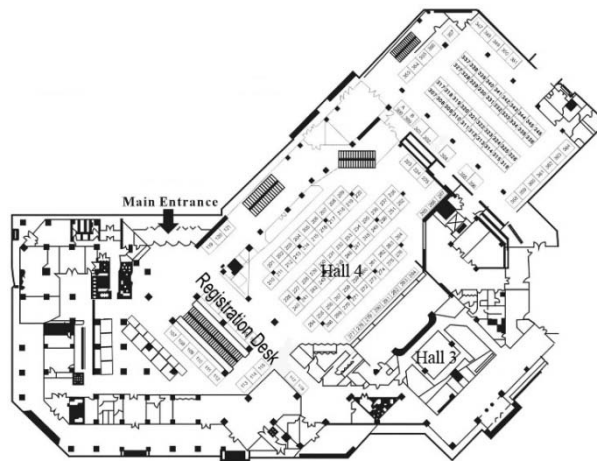

Web Broadcasting

Registered delegates are entitled to viewing web broadcasting of the plenary sessions. Please go to ICDC9 website <http://icdc9.lasg.ac.cn>, click “webcasting” on the left menu, log in and choose the plenary sessions that you want to watch.

Catering

Morning and Afternoon Tea Breaks

Tea breaks will be served in the Exhibition Hall 4 (where the posters and booths are).

Lunch

Lunch is included in the registration fee of general participants. Lunch coupons are inside the envelope given to you when you register. You must present your coupon in order to obtain lunch.

- Lunch buffet, Lijiang Hall of Beijing Continental Grand Hotel, Mon. 3 June
- Lunch box, Hall 4, BICC, Tue. 4 June
- Lunch box, Hall 4, BICC, Wed. 5 June
- Lunch buffet, Lijiang Hall of Beijing Continental Grand Hotel, Thurs. 6 June
- Lunch box, Hall 4, BICC, Fri. 5 June

Icebreaker and Banquet

- Icebreaker, 1700-1900, Lijiang Hall of Beijing Continental Grand Hotel, Sunday 2 June 2013 (**coupon required**)
- Welcome Banquet, 1900 (buses departure at 18:30 from BICC square), Dazhaimen Restaurant, Monday 3 June 2013 (**invitation card required**)

Nearby Cafes and Restaurants

There are many cafes and restaurants near BICC and Beichen Times. There's a supermarket and a shopping mall (Beichen Times) near Yayuncun Hotel. Have fun with Chinese food and language!

Social Program

City tours on Wednesday afternoon are included in the registration fee of general participants and accompanying persons. Please pick up your ticket at the registration desk not later than Monday if you want to join the tour. Passport info is needed to purchase insurance for you.

All city tours will depart at 1330 on 5 June 2013 from BICC. The tour guide will collect your ticket when you get on the bus.

ICDC9 PLENARY PROGRAM

Hall No.3, 1st Floor, BICC

Plenary, Monday, 3 June

0830-1900

Theme 1: Past and present changes and variabilities

T1-1 Chair: N. Zeng

- 0820 **Opening**
- 0830 **[invited]** From "ICDC1" in Bern 1981 to ICDC9 in Beijing 2013 a review of global carbon cycle research during the past three decades
M. Heimann
- 0900 Inverse modeling of the ice age carbon cycle through a combination of simulated and real sediment cores worldwide
C. Heinze, B. Hoogakker
- 0920 Peatland carbon dynamics in warm climates: past and future
Z. Yu
- 0940 A revised atmospheric $\delta^{13}\text{C}$ - CO_2 record covering the last 1000 years from Law Dome and South Pole, Antarctica
M. Rubino

1000 Tea Break

T1-2 Chair: G. McKinley

- 1030 Global ocean carbon uptake: magnitude, variability and trends
R. Wanninkhof, G. Park, T. Takahashi, et al.
- 1050 Sea-air CO_2 fluxes in the Southern Ocean: 1990–2009
A. Lenton, B. Tilbrook, R. Law, D. Bakker, et al.
- 1110 Seasonal to interannual variability of the global ocean carbon sink (1998-2007)
P. Landschützer, U. Schuster, D. Bakker, et al.
- 1130 Decadal trends of CO_2 fluxes from a global joint ocean-atmosphere inversion
K. Steinkamp, N. Gruber

1150 Meeting logistics

1200 Lunch Break

T1-3 Chair: A. Jain

- 1330 **[invited]** Inter-annual variability of the global land carbon sinks
S.L. Piao, P. Ciais, Corinne Le Quéré, et al.
- 1400 Global land-atmosphere exchanges of CH_4 and N_2O in the past three decades: Toward a full GHG budget of the terrestrial biosphere
H.Q. Tian, C. Lu, G. Chen, et al.
- 1420 20 years land carbon fluxes and stocks reanalysis from a Carbon Cycle Multi-Data Assimilation System using in-situ FluxNet, satellite NDVI, and atmospheric CO_2 observations to optimize a process-based model
P. Peylin, N. MacBean, C. Bacour, et al.
- 1440 First net annual carbon balances of the Amazon basin from in-situ vertical profile sampling
L. Gatti, M. Gloor, J. Miller, et al.

1500 Tea Break

T1-4 Chair: S. Denning

- 1530 **[invited]** Highlights and reflections on the Global Carbon Budget
C. Le Quéré, P. Canadell

- 1600 Recent changes in the inter-hemispheric CO_2 difference in relation with fossil fuel emissions and sinks
P. Ciais

- 1620 Large-scale increase in the seasonal cycle of CO_2 in the Northern Hemisphere since 1960
H. Graven, S. Piper, P. Patra, et al.

- 1640 Explaining recent anomalies in the growth of atmospheric CO_2
P. Rayner, A. Stavert, M. Scholze, et al.

1700 Poster Viewing

1900 **Conference Banquet (buses depart at 1830 from BICC)**

Plenary, Tuesday, 4 June

0830-1900

Theme 2: Carbon sources and sinks, their changes and trends

T2-1 Chair: K. Caldeira

- 0830 **[invited]** Ocean carbon sequestration: controlling mechanisms and responses to global changes
N.Z. Jiao

- 0900 The oceanic accumulation of anthropogenic CO_2 since the mid 1990s
N. Gruber, D. Clement, T. Tanhua, et al.

- 0920 Anthropogenic and Climate impacts on the total CO_2 increase observed in the South Indian Ocean
C. Lo Monaco, N. Metzl, A. Lenton, et al.

- 0940 Global trends in surface ocean pCO_2 from in-situ data
A. Fay and G. McKinley

1000 Tea Break

T2-2 Chair: R. Wanninkhof

- 1030 Global Stream and River CO_2 Evasion
P. Raymond

- 1050 Fluxes and controls of CO_2 in the coastal ocean: river dominated margins vs ocean dominated margins?
M.H. Dai

- 1110 Coupled terrestrial-coastal ocean modeling of carbon-cycle processes in the Mississippi-Atchafalaya Basin and northern Gulf of Mexico
S. Lohrenz, W. Cai, H. Tian, et al.

- 1130 Carbon Budget and its Anthropogenic Perturbation in the Land-Ocean Aquatic Continuum
P. Regnier, P. Friedlingstein, **P. Ciais**, et al.

1150 ICDC9 Special Issue Announcement

1200 Lunch

Side event: Surface Ocean CO_2 Atlas (SOCAT): Release of Version 2 and Science Highlights (Room 307)

T2-3 Chair: J. Chen

- 1330 **[invited]** Recent progresses of the program "Carbon Budget and Relevant Issues in Response to Climate Change"—a strategic priority research program of the Chinese Academy of Sciences
D.R. Lu
- 1400 Increased precipitation modifies plant and ecosystem responses to warming in the High Arctic
U. Seibt, K. Maseyk, C. Lett, et al.
- 1420 Global Terrestrial Carbon Budget in Recent 30 Years Simulated Using the BEPS Model Driven by MODIS and AVHRR Data
W.M. Ju
- 1440 Trends and drivers of regional sources and sinks of carbon dioxide over the past two decades
G. Murray-Tortarolo, S. Sitch, et al.

1500 Tea Break

T2-4 Chair: A. Michalak

- 1530 **[invited]** Global greenhouse gas observation by GOSAT and its contribution to carbon flux estimation
T. Yokota and Members of GOSAT Project National Institute for Environmental Studies
- 1600 Global CO₂ flux estimation using GOSAT: An inter-comparison of inversion results
S. Houweling, S. Basu, F. Chevallier, et al.
- 1620 Space-based carbon monitoring by GOSAT and GOSAT-2: lessons learned from GOSAT in-orbit operation and towards better accuracy of XCO₂ observation
H. Suto, A. Kuze, K. Shiomi, M. Nakajima
- 1640 Joint inversion of CO₂ and δ¹³C in CO₂ observations with CarbonTracker
W. Peters, I. vanderVelde, J. Miller, et al.

1700 **Poster Viewing**

- 1830 **Side event: Global Carbon Project: Open discussion on future research** (Room 307)

Parallel, Wednesday, 5 June 0830-1200

Morning: Please refer to Parallel Program on page 9.
Afternoon: City Tours

Plenary, Thursday, 6 June 0830-1900

Theme 2: Carbon sources and sinks, their changes and trends

T2-5/T3-1 Chair: C. Le Quere

- 0830 **[invited]** China's economic growth and the global carbon budget
Y. Qi
- 0900 Refined estimate of China's CO₂ Emissions: provincial inventory and spatiotemporal distributions
H.K. Wang, M. Liu, H. Wang, T. Oda
- 0920 An approach to assessing benefits of advanced global carbon observation system
S. Fuss, M. Gusti, M. Tavoni, et al.
- 0940 Using atmospheric radiocarbon (14CO₂) to constrain fossil and biogenic CO₂ fluxes
J. Miller, S. Lehman, A. Andrews, C. Sweeney

1000 Tea Break

T2-6 Chair: P. Ciais

- 1030 Predictability of the terrestrial carbon cycle
Y.Q. Luo, T. Keenan, M. Smith
- 1050 Atmospheric inversion of the European CO₂ ecosystem fluxes: evaluation of the uncertainty estimates
G. Broquet, N. Kadyrov, F. Chevallier, et al.
- 1110 Reconciling global and regional trends in LULUCF fluxes
J. House, R. Houghton, A. Jain, et al.
- 1130 Terrestrial ecosystems full carbon account as a fuzzy system: an attempt to understand uncertainties
A. Shvidenko, D. Schepaschenko, et al.

1150 Lunch Break

Parallel, Thursday, 6 June 1330-1700

Please refer to Parallel Program on page 10.

- 1830 **Side event: Shaping tomorrow's carbon cycle research: Knowledge gaps, international collaboration, and funding priorities** (Room 307)

Plenary, Friday, 7 June 0830-2100

Theme 3: Future of the carbon cycle: drivers, vulnerabilities, feedbacks and management options

T3-1 Chair: Y. Luo

- 0830 **[invited]** Cumulative responses, progressive effects and feedbacks in ecosystem responses to rising atmospheric CO₂
B. Hungate
- 0900 Regulatory mechanisms on climate-carbon cycle feedback
S.L. Niu
- 0920 The impact of nitrogen and phosphorous limitation on the estimated terrestrial carbon balance and warming of land use change over the last 150 years
Y.P. Wang, Q. Zhang, A. Pitman, D. Dai
- 0940 Using a coupled regional climate and vegetation model to assess the future of Arctic terrestrial ecosystem carbon exchange
W.X. Zhang, C. Jansson, P. Miller, et al.

1000 Tea Break

T2-7 Chair: R. Keeling

- 1030 Emissions of CH₄ from natural gas production in the United States using aircraft-based observations
C. Sweeney
- 1050 On network design for the detection of urban greenhouse gas emissions: Results from the Indianapolis Flux Experiment (INFLUX)
N. Miles, M. Cambaliza, K. Davis, et al.
- 1110 Atmospheric verification of point source fossil fuel CO₂ emissions
J. Turnbull, L. Keller, G. Gordon, et al.
- 1130 An Update on the Total Carbon Column Observing Network
N. Deutscher, D. Griffith, J. Notholt, et al.

1150 Lunch
1200 **Side event: Carbon Monitoring System(Hall 3)**

T3-2 Chair: P. Canadell

1330 **[invited]** Transformational pathways toward mitigating anthropogenic climate change and the future of the carbon cycle: From decarbonization to “negative” emissions

N. Nakicenovic

1400 The combined impacts of ocean acidification, upwelling and respiration processes on aragonite saturation state along the Washington-Oregon-California Continental Shelf Margin during the late summer months of 2011 and 2012

R. Feely, S. Alin, B. Hales, **J. Mathis**, D. Greeley

1420 Large changes in seasonality of the surface ocean carbon cycle under anthropogenic climate change

K. Rodgers

1440 Impact of rapid sea-ice reduction in the Arctic Ocean on the rate of ocean acidification

A. Yamamoto, **M. Kawamiya**, A. Ishida, et al.

1500 Tea Break

T3-3 Chair: M. Heimann

1530 **[invited]** Fossil fuel energy resources: an uncertainty of climate change

J. Murray

1600 Climate change mitigation as opportunities for low-carbonised and sustainable development, the case study of urban mobility in China

Q. Jiang

1620 Analysis of the climate change mitigation potential of Canada's forest sector

W. Kurz, C. Smyth, T. Lempriere, et al.

1640 Ocean and land climate-carbon cycle feedbacks at the regional scale: a analysis based on CMIP5 models

L. Bopp and C. Jones

1700 Open Discussion

1730 End of Conference



ICDC9 PARALLEL PROGRAM

Parallel, Wednesday, 5 June 0830-1200

Room 305AB, 3rd floor: Atmosphere

Chair: B. Stephens

- 0830 Three-dimensional behaviors of atmospheric CO₂ revealed by the CONTRAIL project and their significance in inverse flux estimates
T. Machida, Y. Sawa, Y. Niwa, H. Matsueda
- 0845 Carbon balance of China constrained by CONTRAIL aircraft C O₂ measurements and an updated C O₂ emission inventory of China
F. Jiang, H.M. Wang, J.M. Chen, T. Machida, et al.
- 0900 Quantifying CO₂ emissions from Canada's oil sands developments-results from a multi-tracer atmospheric observational/modeling approach
M. Kim, **J. Lin**, L. Huang, D. Worthy
- 0915 On the detection of trends in arctic carbon emissions
L. Bruhwiler, E. Dlugokencky, P. Tans, K. Masarie
- 0930 Isotope- and tracer- based measurements of fossil fuel and biospheric carbon dioxide in Paris during winter 2010
M. Lopez, M. Schmidt, M. Delmotte, et al.
- 0945 The Macquarie Island in situ CO₂ record: instrumentation, calibration, baseline selection and climatology
A. Stavert, M. van der Schoot, R. Law, S. Chambers

1000 Tea Break

Chair: W. Buermann

- 1030 Interannual variability in the Northern Hemispheric seasonal cycle of CO₂ as observed by GOSAT
S. Basu, S. Guerlet, A. Butz, M. Krol, et al.
- 1045 33 years of CO₂ surface fluxes as seen from the atmosphere
F. Chevallier
- 1100 Strong observational constraints on seasonal northern extratropical CO₂ exchange
B. Stephens, S. Wofsy, J. Bent, et al.
- 1115 Fingerprints of climate variability on atmospheric CO₂
G. Keppel-Aleks, J. Randerson
- 1130 Unraveling the role of volcanic eruptions and interdecadal modulation of El Niño-Southern Oscillation amplitudes in recent changes of the global carbon cycle
T. Froelicher, F. Joos, K. Rodgers, et al.
- 1145 Variations in atmospheric Carbon Dioxide and its association with rainfall and vegetation over India
Y. Tiwari, J.V. Revadekar, Ravi Kumar

1200 Lunch Break

Room 305CD, 3rd floor: Land

Chair: G. Zhou

- 0830 On the effect of climate extremes on the carbon cycle from ecosystem to globe
M. Reichstein, M. Bahn, P. Ciais, et al.
- 0845 Investigating an abrupt change in the land uptake of carbon in 1989
W. Buermann, C. Beaulieu, D. Medvigy et al.
- 0900 Impacts of drought-induced forest mortality on global forest carbon sinks: recent progress and future challenges
C.H. Peng

- 0915 Evaluations of the spatial and temporal variations of biomass burning emissions in Southeast Asia during 2001-2010
Y. Shi, T. Sasai
- 0930 Vulnerability of carbon cycle in various ecosystems of Central Russia to heat waves and droughts
I. Kurganova, V. L. de Gerenyu, I. Savin
- 0945 Effects of drought on forest ecosystems carbon cycle in China during 2001-2010
S. Wang, L. Zhou, W. Ju, R. Liu

1000 Tea Break

Chair: M. Scholze

- 1030 High soil organic carbon losses from peaty croplands
A. Freibauer
- 1045 14C evidence of enhanced permafrost carbon export in response to Arctic climate variations
X.J. Feng, J.E. Vonk, B. van Dongen, et al.
- 1100 The process attribution and model predictability of North American biospheric CO₂ flux as informed by atmospheric measurements
Y.Y. Fang, Y. Shiga, V. Yadav
- 1115 On the use of Carbonyl Sulfide (COS) as a tracer for estimates of Gross Primary Production (GPP)
H.L. Chen, S. Montzka, A. Andrews, et al.
- 1130 Priming Effects on Forest-Carbon Storage
D. Schaefer, N. Qiao, X.L. Xu
- 1145 Change of terrestrial carbon storage since the Last Glacial Maximum in China and its effect on atmospheric CO₂ concentration
H.B. Wu, Z. Guo, J. Guiot

1200 Lunch Break

Room 307, 3rd floor: Ocean and other aquatic systems

Chair: N. Gruber

- 0830 Regional distribution and seasonal mechanisms of carbon uptake in the global oceans
G. Mckinley, S. Doney, R. Feely, et al.
- 0845 Variability of the northern hemisphere air-sea CO₂ flux over the last decade
U. Schuster, A. Watson, S. Nakaoka, Y. Nojiri
- 0900 Detecting the anthropogenic influence on recent changes in ocean carbon uptake
R. Séférian, A. Ribes, L. Bopp
- 0915 The Non-Steady-State oceanic CO₂ signal: its importance, magnitude and a novel way to detect it
B. McNeil, R. Matear
- 0930 Carbon 13, an additional constraint to reveal anthropogenic carbon uptake in the Southern Indian Ocean
V. Racapé, N. Metzl, C. Pierre, et al.
- 0945 GLODAPv2 – a global and quality controlled ocean biogeochemical data product
S.K. Lauvset, R.M. Key, A. Olsen, et al.

1000 Tea Break

Chair: K. Rodgers

- 1030 Carbon dioxide (CO₂) distribution and air-sea flux in the Mississippi River dominated continental shelf, northern Gulf of Mexico
W. Cai, W. Huang, S. Lohrenz, et al.

- 1045 Spatial and seasonal variability of CO₂ evasion from rivers
R. Lauerwald, G. Laruelle, J. Hartmann, P. Regnier
- 1100 Quantifying the air-sea CO₂ exchange of continental shelf seas at the global scale: a regionalized data driven approach
G. Laruelle, R. Lauerwald, J. Rotschi, et al.
- 1115 Carbon transfers between ocean surface and interior: physical pathways
M. Levy
- 1130 Interaction of ocean acidification and deoxygenation in the Northeast Pacific Ocean
Z. A. Wang, S. Chu, K. Hoering
- 1145 Ocean acidification in the tropical Pacific from below
M. Ishii, D. Sasano, N. Kosugi, et al.

1200 Lunch Break

Parallel, Thursday, 6 June 1330-1700

Room 305AB, 3rd floor: Atmosphere

Chair: D. Baker

- 1330 Atmospheric inversion of the surface CO₂ flux with 13CO₂ constraint
J. Chen, G. Mo, F. Deng
- 1345 Simultaneous optimisation of process parameters in a terrestrial and marine carbon cycle model using atmospheric CO₂ concentrations
M. Scholze
- 1400 A Chinese joint-assimilation system (Tan-Tracker) to simultaneously estimate surface CO₂ fluxes and 3-D atmospheric CO₂ concentrations from observations: formulation and OSSEs for insitu-observations
X.J. Tian
- 1415 A new data assimilation approach for estimating surface carbon flux distribution
X.G. Zheng, S. Zhang, B. Dan, et al.
- 1430 Comparison of carbon Tracker-Asia CO₂ flux with Asia flux tower measurement and CASA biogeochemical model data
S.-J. Lee, **J. Kim**, C.H. Cho
- 1445 Estimation of European Methane emissions using a regional-scale atmospheric inversion system
U. Karstens, C. Rödenbeck, C. Gerbig, et al.

1500 Tea Break

Chair: C. Roedenbeck

- 1530 Revisiting the rectifier: covariance of mixing & metabolism derived from spaceborne LIDAR
S. Denning, E. McGrath-Spangler
- 1545 Atmospheric 14CO₂ at Point Barrow, Alaska, from 2003 to 2013
X.M. Xu, S. Trumbore
- 1600 Estimation of surface fluxes of carbon from atmospheric data assimilation
J.-S. Kang, E. Kalnay, J. Liu, I. Fung, and T. Miyoshi
- 1615 Atmospheric inversion with CONTRAIL exposing CO₂ dynamics in the Asian tropics
Y. Niwa, T. Machida, Y. Sawa, et al.
- 1630 Monitoring carbon emissions at the regional scale: first of its kind reconciliation of inventory and atmospheric inversion methods
T. Lauvaux, A. Schuh, Stephen Ogle, et al.
- 1645 Joint inverse modeling of surface CO₂ fluxes using satellite and surface observations of CO₂ mixing ratio
F. Deng, N. Bousserrez, K. Bowman, et al.

Room 305CD, 3rd floor: Land

Chair: C. Peng

- 1330 The GHG balance of a country with substantial land management, the Netherlands
H. Dolman
- 1345 Role of large trees in sequestering carbon
P. Kauppi, Y. Pan, R. Birdsey, P. Nöjd
- 1400 Management effects on GHG exchanges in a boreal forest
A. Lindroth, P. Vestin, M. Mölder, et al.
- 1415 Modelling organic carbon stocks in croplands of China under different agricultural management and climate change scenarios
Y.Q. Yu
- 1430 The global carbon cycle simulated by a climate system model-BCC_CSM
W.P. Li, X. Shi, T. Wu, et al.
- 1445 The causes and implications of persistent atmospheric carbon dioxide biases in Earth system models
F. Hoffman, J. Randerson

1500 Tea Break

Chair: Y. Huang

- 1530 Investigating the urban CO₂ excess of the Greater Toronto Area using two sister sites
F. Vogel, E. Chan, L. Huang, et al.
- 1545 Carbon Balance of peatlands at south taiga of west Siberia
E. Golovatskaya, E. Golovatskaya, E. Duykarev, E. Veretennikova
- 1600 Atmospheric CO₂ exchange in urban neighborhoods measured by eddy covariance
E. Velasco, M. Roth, L. Norford
- 1615 Model-data synthesis of terrestrial carbon cycles in Asia: CarboEastAsia perspective
K. Ichii, M. Kondo, Y. Okabe, et al.
- 1630 Using Earth Observation (EO) data to constrain leaf phenology of the terrestrial biosphere model ORCHIDEE
N. MacBean, F. Maignan, P. Peylin, C. Bacour
- 1645 Soil abiotic CO₂ exchange over alkaline areas
W. Wang, **X. Chen**

Room 307, 3rd floor: Ocean, aquatic systems, and CO₂ monitoring

Chair: L. Bopp

- 1330 The direct effects of increasing CO₂ concentration in seawater on net primary production of charophytes in the shallow coastal brackish water ecosystem
L. Pajusalu, G. Martin, A. Põllumäe, K. Torn
- 1345 Uptake, storage and transport of CO₂ in an ocean biogeochemistry general circulation model
Y.C. Li, Y.F. Xu
- 1400 Growing future north-south difference in atmospheric CO₂
J. Orr, P. Cadule, L. Bopp, et al.
- 1415 Decreasing North Atlantic CO₂ uptake: a robust feature of future model simulations
I. Totterdell, P. Halloran, C. Voelker
- 1430 Climate carbon-cycle feedbacks over Southern Ocean Water masses: a CMIP5 multimodel diagnosis
T. Roy, J.-B. Sallee, N. Metzl, et al.
- 1445 CO₂ fluxes from boreal aquatic ecosystems based on eddy covariance measurements
A. Ojala, **J. Huotari**, **J. Heiskanen**

1500 Tea Break

Chair: A. Michalak

- 1530 An update to the Surface Ocean CO₂ Atlas (SOCAT)
D.C.E. Bakker, S. Hankin, A. Olsen, et al.
- 1545 The U.S. Carbon Cycle Science Program: Overview and Highlights
Z. Zhu, J. Whetstone, D. Wickland, et al.
- 1600 Detecting the fossil fuel emissions signal from atmospheric CO₂ measurements using inverse methods
Y. Shiga, A. M. Michalak, V. Yadav, et al.
- 1615 Detecting power plant emissions signatures from space
T. Oda, S. Maksyutov, H. Boesch, et al.
- 1630 Towards disentangling natural and anthropogenic GHG emissions by space-based atmospheric concentration imaging - CarbonSat ESA Earth Explorer 8 Candidate Mission
H. Bovensman
- 1645 The carbon sequestration of Chinese cement consumption and cement kiln dust (CKD) treatment in past 110 years
F.M. Xi, R. Wu, Z. Liu

POSTER LISTING

All posters are on display for the whole conference period in Hall 4.

Poster Theme 1: Past and present changes and variabilities

- P1 A new real-time global atmospheric CO₂ forecast product: evaluation and sensitivity to model resolution
A. Agusti-Panareda, S. Massart, F. Cevallier
- P2 Can we use δ¹³C of CO₂ to understand the links between the water and carbon cycles and climate?
C. Alden, J. White, J. Miller, et al
- P3 Could global carbon cycle models explain the seasonal cycle of the atmospheric carbon storage?
G. Alexandrov
- P4 Vertical Distributions of Greenhouse Gases in the Stratosphere over the Eastern Equatorial Pacific
S. Aoki
- P5 Impact of two typhoon cases on meteorological elements and CO₂ concentration over East Asia region by the regional model WRF-CO₂
S. Ballav, P. K. Patra, M. Takigawa, S. Marayama, et al
- P6 Sixteen Years of Carbon Flux Measurements Above a Mixed Forest at Borden Ontario Canada
N. Froelich, R. Staebler, A. Barr, **P. Bartlett**
- P7 Patterns and Controls on Soil Respiration in a Deciduous Mixed Forest near Borden, Ontario
P. Bartlett
- P8 Global patterns of ecosystem carbon turnover rates – contrasting data and models
N. Carvalhais, M. Forkel, M. Khomik, et al.
- P9 SST phases in the open-ocean and margins of the tropical Pacific: implication on tropical climate dynamics and greenhouse emission
M.-T. Chen, L.-J. Shiau
- P10 Surface water fCO₂ algorithms for the high-latitude Pacific sector of the Southern Ocean
M. Chierici, S. R. Signorini, A. Fransson, A. Olsen
- P11 Observation and modeling of an annual course of soil respiration at urban area
E. Dyukarev
- P12 A study of the South Atlantic Ocean: Circulation and Carbon Variability
G.R. Evans, E.L. McDonagh, B.A. King, et al.
- P13 Temporal monitoring of the air-water CO₂ exchange in a Mediterranean Wetland
S. Flecha, E. P. Morris, G. Navarro, I. E. Huertas
- P14 Carbon monitoring in the Strait of Gibraltar: tracking the Mediterranean CO₂ content
S. Flecha, G. Navarro, ... and **I.E. Huertas**
- P15 Antarctic sea ice CO₂ system and controls
A. Fransson, M. Chierici, W. O. Smith Jr.
- P16 Carry over effects of warming-induced earlier leaf flushing on next year's leaf phenology in two temperate tree species
Y.S. Fu, M. Campioli, Y. Vitasse, et al.
- P17 Application of the ensemble meteorology for CO₂ concentration simulations at continuous observation sites
A. Ganshin, R. Zhuravlev, H. Mukai, et al.
- P18 Continuous measurements of the atmospheric O₂/N₂ ratio at suburban and coastal sites in the northeastern part of Japan
D. Goto, S. Morimoto, S. Ishidoy, et al.
- P19 High-precision continuous measurements of the atmospheric O₂/N₂ ratio initiated at Ny-Ålesund, Svalbard
D. Goto, S. Morimoto, S. Aoki, T. Nakazawa
- P20 Surface atmosphere and ocean CO₂ dataset obtained by NIES volunteer observation ship program in the Pacific
S. Harasawa
- P21 The ocean biogeochemistry at the onset of the Paleocene-Eocene Thermal Maximum – an Earth System Model study
M. Heinze and T. Ilyina
- P22 Inverse modeling of the ice age carbon cycle through a combination of simulated and real sediment cores worldwide
C. Heinz and B. Hoogakker
- P23 The effect of agricultural ecosystems on the regional carbon flux of the five countries in Central Asia in the past 25 years
Y. Hui
- P24 Long-term variability of sea-air CO₂ flux distribution over the global ocean analyzed by JMA
Y. Iida, A. Kojima, K. Enyo, et al.
- P25 Gravitational separation of major atmospheric components in the stratosphere and its application as an indicator of atmospheric circulation
S. Ishidoya, S. Sugawara, S. Morimoto, et al.
- P26 A decadal inversion of carbon dioxide using the Global Eulerian-Lagrangian Coupled Atmospheric model (GELCA)
M. Ishizawa, T. Shirai, R. Zhuravlev, A. Ganshin, et al.
- P27 Impact of high resolution meteorological fields on simulation of high frequency variability of CO₂ concentration using FLEXPART with 1km flux maps
R. Janardanan, Y. Niwa, A. Ganshin, et al.
- P28 Ocean Acidification and CO₂ Fluxes in the Pacific-Arctic Region
M. Jeremy, W. Evans, C. Hauri, et al.
- P29 Temperature response of soil CO₂ efflux in a Chinese pine plantation: temporal hysteresis and spatial variability
X. Jia, T. Zha, B. Wu, et al.
- P30 Air-sea CO₂ flux interannual variability correlated with climate indices
S. Jones, C. Le Quéré, C. Rödenbeck, A. Manning
- P31 Consistency between top-down and bottom-up estimates of the CO₂ budget of Europe
T. Kato, P. Ciais, P. Peylin, et al.
- P32 Seasonal changes of CO₂, CH₄ and N₂O in the upper troposphere/lower stratosphere over the Eurasian continent observed by commercial airliner
T. Kazuhiro, T. Machida, Y. Sawa, et al.
- P33 Atmospheric O₂ measurements since 1990
R. Keeling, A. Manning
- P34 Temporal variation on soil carbon storage following thinning treatments in red pine stands
C. Kim, K. Lee, Y. Son, S. Lee, S. Kim
- P35 Intra- and Inter-annual Variation of Stem Respiration of Black Spruce (Picea mariana), Interior Alaska
Y. Kim, S. Kim
- P36 Larval and post-larval stages of Pacific oyster (Crassostrea gigas) are resistant to elevated CO₂
G. Ko
- P37 Atmospheric signatures of air-sea exchanges of CO₂, O₂/N₂, CH₄, CO, and N₂O recorded at the Cape Verde Atmospheric Observatory (CVAO)
E. Kozlova, R. Leppert and M. Heimann

- P38 Trends in anthropogenic carbon in water masses of the Subtropical North Atlantic Ocean along 24.5 degrees North
O. Legge, N. Fajar, E. Guallart, P. Brown, et al.
- P39 Comparison of continuous in-situ CO₂ observations at Jungfraujoch, Switzerland using two different measurement techniques
M. Leuenberger, M. Steinbacher, B. Buchmann, et al.
- P40 First tall tower installation in Switzerland for greenhouse gas concentration monitoring within CarboCount-CH
M. Leuenberger, D. Brunner, B. Oney, W. Eugster, et al.
- P41 Ecosystem Carbon Exchange of Two Subtropical Mangrove Ecosystems in China under Influences of Mariculture, Typhoons and Insect Outbreaks
G. Lin, H. Chen, W. Liu, S. Yang
- P42 Retrospective retrieval of long-term consistent global leaf area index since 1981 for carbon cycles research
R. Liu, Y. Liu, J. Chen
- P43 Sensitivity of regional energy, water, and carbon cycles to historical land-cover changes in the Eastern United States since European Settlement
L. Lu and R. Pielke
- P44 The flux of carbon from land-use over 1979-2011 in Central Asia
G. Luo, H. Ye, Q. Han, Y. Wang, X. Chen
- P45 Assessing the new generation of Earth System Models with satellite and atmospheric observations: a carbon and oxygen cycle perspective
M. Manizza, C. Nevison, R. Keeling, M. Kahru
- P46 Southern Ocean processes and variability from a 13 year record of in situ atmospheric O₂ and CO₂ measurements made at Baring Head, New Zealand
A. Manning, G. Brailsford, B. Stephens, et al.
- P47 South Atlantic CO₂ and CH₄ growth and dynamics observed by continuous high-precision measurement at Ascension Island, East Falkland Island and onboard RRS JC Ross
A. Lowry, R. Fisher, ..., **A. Manning**, et al.
- P48 Long-term change of the CO₂ latitudinal gradient in the upper troposphere
H. Matsueda, T. Machida, Y. Sawa, Y. Niwa
- P49 Ocean dynamical and biological controls of variability in the latitudinal gradient of CO₂ and O₂/N₂ across the Pacific Ocean
S. Mikaloff Fletcher, K. Rodgers, O. Aumont, et al.
- P50 Temporal variations of concentration and isotope ratios of atmospheric methane observed at Ny-Ålesund, Svalbard
S. Morimoto, T. Umezawa, S. Aoki, et al.
- P51 Trends of long-term changes of CO₂ and other related gases concentrations in the atmosphere at Hateruma and Ochi-ishi stations in Japan - influence of Asian emissions
H. Mukai, S. Hashimoto, Y. Terao, et al.
- P52 Decadal changes in dissolved inorganic carbon in the ocean
A. Murata, S. Kouketsu, T. Doi
- P53 Inter-annual variations and long-term trends in the carbon budget and atmospheric CO₂ in a cool-temperate deciduous forest ecosystem of central Japan
S. Murayama, S. Ishidoya, N. Saigusa, et al.
- P54 Seasonal variations of CO₂, CH₄, N₂O and CO in the mid-troposphere over the western North Pacific observed by a cargo aircraft C-130H
Y. Niwa, K. Tsuboi, H. Matsueda, et al.
- P55 Analysis of Asian regional characteristics on greenhouse gaseous concentrations obtained by NIES flask sampling network
S. Nomura
- P56 Development of balloon-borne CO₂ instruments (CO₂sonde) for the troposphere and comparison with aircraft measurements
M. Ouchi, K. Miyaji, Y. Matsumi, et al.
- P57 First measurements of major greenhouse gases in Bangladesh
K. Ahmed, T. Machida, H. Mukai, **P. Patra**, et al.
- P58 Interannual Variations in the Seasonal Cycle of Atmospheric CO₂ at Mauna Loa, Hawaii
S. Piper, R. Keeling, P. Patra, L. Welp
- P59 The seasonal cycle of the δ¹³C_{DIC} in the North Atlantic Subpolar Gyre
V. Racapé, N. Metzl, **C. Pierre**, et al.
- P60 Global sea-air CO₂ flux variability from an ocean mixed-layer scheme driven by SOCAT pCO₂ observations
C. Roedenbeck, D. Bakker, N. Metzl, et al.
- P61 A multimodel evaluation of the seasonal marine carbon cycle and its drivers in CMIP5 and CMIP Earth system models
T. Roy, A. Lenton, N. Metzl, et al.
- P62 CO₂ profiles retrieved from GOSAT/TANSO-FTS thermal infrared spectra using an improved algorithm
N. Saitoh and R. Imasu
- P63 Continuous measurements of CO₂ concentration from a tower network (JR-STATION) over Siberia
M. Sasakawa, T. Machida, N. Tsuda, et al.
- P64 Oxygen Decrease with Bidecadal Oscillations in the Northwestern Pacific
D. Sasano, Y. Takatani, N. Kosugi, et al.
- P65 Variability of CO₂ mixing ratios observed in the upper troposphere revealed by frequent continuous observations by commercial airliner
Y. Sawa, T. Machida, H. Matsueda, Y. Niwa
- P66 Effects of tropical cyclones on the air-sea flux of CO₂
U. Schuster
- P67 Interannual variability of sea surface pH
U. Schuster
- P68 A Multi-Year Record of Airborne CO₂ Observations in the US Southern Great Plains
B. Sebastien, M. Torm, J. Smith, et al.
- P69 Sensitivity of speleothem δ¹³C signals to vegetation viewed from global cave monitoring
J. Shen, M. Tan, H. Wu, et al.
- P70 Ecosystem light use efficiency and water use efficiency along an Australian precipitation transect
H. Shi and L. Li
- P71 Change of air-sea CO₂ flux in East and South China Sea
Z. Song and D. Zhao
- P72 Long-term variation of the stratospheric CO₂ over Japan
S. Sugawara, S. Aoki, T. Nakazawa, et al.
- P73 Frequency Response of Sensors for CO₂ Flux Measurements
M. Quadros, S. Hall, **D. Telionis**
- P74 Observations of atmospheric radiocarbon in carbon dioxide at Hateruma Island and Cape Ochi-ishi, Japan: Trends, Interannual variability and seasonal cycle from 2004 to 2012Y.
Y. Terao, H. Mukai
- P75 Multi decadal trend in oceanic surface pCO₂ from observation and models
J. Tjiputra, A. Olsen, L Bopp, et al.
- P76 Observed interannual variability in latitudinal distribution of annual mean atmospheric potential oxygen (APO) in the Western Pacific
Y. Tohjima, H. Mukai, T. Machida, et al.
- P77 Annual and monthly Gross Primary Productivity time series (2000 – 2012) for Europe on a 1km² resolution
M. Tum, K. Günther, K. Wißkirchen
- P78 Interdecadal carbon uptake variability in the southern subtropical Indian Ocean
V. Valsala, S. Maksyutov, R. Murtugudde

- P79 Intraseasonal variability of terrestrial biospheric C O₂ fluxes over India during summer monsoons.
V. Valsala, Y. Tiwari, P. Pillai, et al.
- P80 The impact of the Global Financial Crisis on atmospheric CO₂
M. van der Schoot
- P81 The Spatio-temporal Variation of Phytoplankton Community Structure and Its Coupling to Particles Organic Carbon Export in the Northern South China Sea
L. Wang, B. Huang, P. Cai, et al.
- P82 Effects of drought on forest ecosystems carbon cycle in China during 2001-2010
S.Q. Wang, L. Zhou, W. Ju, R. Liu
- P83 Contrasting Decadal Variability in Sea Surface pCO₂ Between the Equatorial Pacific and Atlantic
X.J. Wang, R. Murtugudde, E. Hachert
- P84 Increasing seasonal CO₂ exchange in high northern latitudes
L. Welp, H. Graven, S. Piper, R. Keeling
- P85 Status and Analysis of Jiangsu Province's Carbon Emission Reduction
Y. Wu
- P86 Interannual variability of net ecosystem productivity in forests is explained by carbon flux phenology in autumn
C.Y. Wu, J. Chen
- P87 Satellite Observations of Greenhouse Gases using Thermal Infrared Sounders
X. Xiong, C. Barnet, A. Gambacorta, et al.
- P88 A global analysis of soil microbial biomass carbon, nitrogen and phosphorus in terrestrial ecosystems
X. Xu, P. Thornton, W. Post
- P89 Seasonal variation and its controlling mechanism of sea surface partial pressure of CO₂ in Jiaozhou Bay
M. Xue, L. Zhang, W. Wang
- P90 Drought induced carbon export of peatlands in
G. Yang
- P91 Basin-scale Distribution and Seasonal to Inter-annual Variation of Dissolved Inorganic Carbon over the North Pacific
S. Yasunaka, Y. Nojiri, S. Nakaoka, T. Ono, et al.
- P92 Progress status of the GOSAT SWIR XCO₂ and XCH₄
Y. Yoshida, N. Kikuchi, M. Inoue, et al.
- P93 Prehistoric land use induced changes of terrestrial carbon storage in Wei valley, northern China
Y. Yu, Z. Guo, H. Wu,
- P94 Using Land Surface Temperature and Normalized Difference Index products for desertification monitoring in Bulgan, Mongolia
H. Yu
- P95 Atmospheric CO₂ and water chemistry changes from the past to the present: planktonic foraminifera in the European Arctic (Fram Strait)
K. Zamelczyk, T. Rasmussen, C. Manno, et al.
- P96 Palaeovegetation evolution of the Loess Plateau during warming epochs and its implications for the future
D. Zhao, H. Wu, J. Wu, Q. Li, Y. Zhang, Z. Guo
- P97 Net exchange of terrestrial carbon dioxide in Asia during 2000-2009 estimated from atmospheric inverse modeling
H.N. Zhang, B. Chen, W. Peters
- P98 Simulated soil organic carbon with CENTURY model in the past 50 years in Inner Mongolia grassland
Q.H. Zhang, S. Wu, D. Zhao
- P99 Embodied CO₂ Emissions in Beijing's Domestic and Foreign Trade between 2000 and 2010
Y.X. Zhang, H. Wang, J. Bi, Y. Wang
- P100 Development and test of soil respiration parameterization in Noah_MP land surface model
X. Zhang and G. Niu
- P101 On the seasonal variation of air-sea CO₂ fluxes in continental shelves in temperate zone: a case study in the North Yellow Sea
H.D. Zhao, W. Zhai, S. Shang, et al.
- P102 Impact of the agricultural Green Revolution on the global carbon cycle during 1960-2010
F. Zhao and N. Zeng
- P103 Response of ecosystem carbon fluxes to drought events in a poplar plantation in Northern China
J. Zhou, Z. Zhang, G. Sun, et al.
- P104 Temporal variations in atmospheric CO₂ on Rishiri Island in 2006-2012
C.M. Zhu, H. Yoshikawa-Inoue, Y. Tohjima
- P105 Evaluating inter-annual variation and global pattern of methane emissions from natural wetlands using dynamic global vegetation model
Q. Zhu, C. Peng, J. Liu, H. Chen
- P105+1 Glacial burial and decomposition of ancient organic carbon at King George Island, Antarctica
N. Zeng, J. Gregg, Z. Yu

Poster Theme 2: Carbon sources and sinks, their changes and trends

- P106 A new look at the uncertainty associated with C DIAC estimates of global carbon dioxide emissions from fossil fuel consumption
R. Andres, and T. Boden
- P107 Global Hourly Simulation of Atmosphere-Land CO₂ Exchange with a Process-based Model, VISIT
I. Akihiko, P. Patra
- P108 Quantifying carbon processes of the terrestrial biosphere in a global atmospheric inversion
B. Badawy, C. Rödenbeck, M. Heimann
- P109 Integrating Prognostic Phenology and Carbon Pools in The Simple Biosphere Model (SiB4) to Estimate Fluxes, Biomass and Stocks
K. Haynes, S. Denning, **I. Baker**, et al.
- P110 Constraining Estimates of Global Photosynthesis with Observations of Chlorophyll Fluorescence
I. Baker, J. Berry, C. Frankenberg, J. Lee, S. Denning
- P111 The value of satellite-based CO₂ measurements for constraining carbon source/sink estimates
D. Baker
- P112 Determination of aboveground biomass in a Brazilian subtropical forest
R. Balbinot, F. Breunig, J. Trautenmüller
- P113 Accounting the Carbon Budgets in Agriculture and Forests: Current Model Framework and Challenges
K. Chang, **P. Bartlett**, J. Warland, P. Voroney
- P114 A first in-situ data based annually and seasonally resolved Methane Budget for the Amazon basin
L. Basso, L. Gatti, J. Miller, et al.
- P115 One year of underway δ¹³C(CO₂) data in the North Atlantic Ocean
M. Becker, A. Körtzinger, T. Steinhoff
- P116 Developing adjoint of the coupled Eulerian-Lagrangian transport model for CO₂ inverse modeling
D. Belikov, S. Maksyutov, T. Kaminski, et al.
- P117 The changing marine carbonate system and air-sea flux of the North Atlantic and Arctic Ocean
R. Bellerby, J. Tjiputra, E. Jeansson, et al.
- P118 Variation in Soil Respiration Along a Latitudinally Constant Transect
C. Berridge, A. Ekici, I. Bistinas
- P119 Forty years of baseline CO₂ measurements at Baring Head, New Zealand
G. Brailsford, B. Stephens, S. Mikaloff Fletcher, et al.
- P120 The marine carbonate system in a Southern Ocean deep

- water formation region: accumulation, fluxes and transports from the Weddell Gyre to the global ocean
P. Brown, G. MacGilchrist, D. Bakker, et al.
- P121 Background and Regional CO₂ Measurements from Three Sites within the Cape Peninsula, South Africa
E. Brunke
- P122 Extending Arctic CO₂ column measurements to cover the complete seasonal cycle using Lunar FTIR spectroscopy during Polar Night
M. Buschmann, N. Deutscher, M. Palm, et al.
- P123 Role of GOSAT total column CO₂ observations in the estimation of CO₂ surface fluxes
A. Chatterjee, A. Michalak, C. O'Dell, et al.
- P124 Global cropland monthly gross primary productivity in the year of 2000
T. Chen, G. van der Werf, N. Gobron, H. Dolman
- P125 Impact of Water on the Terrestrial Gross Primary Productivity
J. Liu, **J. Chen**, G. Mo, L. He
- P126 Sources and sinks of carbon from forest land use change in the last 30 years in Xinjiang province, China
Y.L. Chen
- P127 An inverse system of monthly CO₂ surface fluxes from regional characteristics of CO₂ observations
Z. Chen
- P128 Using C* to determine decadal changes in anthropogenic and natural CO₂ in the ocean
D. Clement, N. Gruber
- P129 Exploring the small-scale interactions and feedbacks between croplands and the atmosphere for carbon, water and energy
M. Combe, W. Peters J. Vilà-Guerau, et al.
- P130 A stochastic model for scale interactions in high-latitude peatlands
F. CrestoAleina, V. Brovkin, B. Runkle, L. Kutzbach
- P131 Fossil fuel-derived CO₂ contribution to the urban atmosphere in Guangzhou, South China by ¹⁴C observation, 2010 – 2011
P. Ding, C. Shen, W. Yi
- P132 Research on the Calculation Method of CO₂ Air - sea Flux Based on Seawater CO₂ Solubility
X. Du, and W. Wang
- P133 Research about carbon stocks in secondary forest and gallery forest in Congo
R. EKOUNGOULOU, Suspense IFO
- P134 Stable isotope ratio (¹³C/¹²C) mass spectrometry to evaluate carbon sources and sinks: changes and trends during the decomposition of vegetal debris
I. Fernandez
- P135 First net annual carbon balances of the Amazon basin from in-situ vertical profile sampling
L. Gatti, J. Miller, L. Basso, et al.
- P136 Evolution of the net land sink during the period 1960-2011 in the context of REDD+
F. Gonzalez
- P137 Earth Networks' dense atmospheric GHG observing system C. Sloop, E. Novakovskaia...**H. Graven**
- P138 Estimating CH₄ Emissions Across California with Multi-site Observations
S. Jeong, E. Novakovskaia, A. Andrews, L. Bianco, **H. Graven**, et al.
- P139 Grassland carbon cycling: relationships between C source/sink strength, net primary productivity and grazing
Q. Han
- P140 The Surface Ocean CO₂ Atlas (SOCAT): "automating" community-wide data synthesis
S. Hankin, K. Smith, S. Jones, R. Schweitzer, et al.
- P141 CARBOCHANGE – Changes in Carbon Uptake and Emissions by Oceans in a Changing Climate
F. Hoffmann, C. Heinze, B. Pfeil, the CARBOCHANGE consortium
- P142 Estimation of Satellite-based Growth Primary Production and Validation of Flux tower and ground measurement over South Korea
J. Hong, C. Shim
- P143 The Effect of Traffic Load on Urban CO₂ Concentration
C. Hsieh, S. Cheng, C. Huang
- P144 Ocean margins as an increasing sink for the atmospheric CO₂ – a case study in the US east coast
X. Hu, W. Cai
- P145 Numerical modeling of regional carbon cycle based on RegAEMS
X. Huang, T. Wang
- P146 On a Dynamic Window Inversion Method
S. Han, Y. Li, Q. Huang, T. Wang
- P147 Increasing or stagnating CO₂ in the deep and bottom waters of the Weddell Gyre, Southern Ocean
M. Hoppema, S. van Heuven, E. Jones, et al.
- P148 Carbon dioxide emission from disturbed peat-land in Kalimantan, Indonesia
G. Inoue, M. Kawasaki, A. Sakurai, et al.
- P149 Exchange ratios of ¹⁸O₂:CO₂ observed in a cool temperate deciduous forest ecosystem of central Japan
S. Ishidoya, S. Murayama, C. Takamura, et al.
- P150 CO₂ Emissions from Land use Change Affected More by Nitrogen Cycle, than by the Choice of Land Cover Data
A. Jain, P. Meiyappan, Y. Song, H. House
- P151 Long-term CO₂ fluxes in urban areas – Results from Helsinki and an application for regional carbon budgets
L. Jaervi, A. Nordbo, S. Haapanala, et al.
- P152 Carbon stocks across a stand age sequence in Pinus radiata plantations in South Australia
J. Jeong, D. McGuire, N. Bolan, et al.
- P153 Soil carbon storage as impacted by stand age and site quality of Pinus radiata plantations in South Australia
J. Jeong, D. McGuire, N. Bolan, et al.
- P154 Carbon and nitrogen responses of foliage and litter fall following fertilizer application in a red pine stand
J. Jeong, C. Kim, K. Lee
- P155 Regional carbon footprint accounting for China based on a multi-region input-output framework: a consumption based approach
Y. Jiang, W. Cai, C. Wang
- P156 A Terrestrial Carbon Cycle Data Assimilation System based on the VEGAS model: the observing system simulation experiments (OSSE)
B.H. Jia, N. Zeng, F. Zhao, Z.H. Xie
- P157 Quantifying the impact of model errors on top-down CO₂ flux estimates
D. Jones, W. Lu, F. Deng, S. Polavarapu, et al.
- P158 Vulnerability of ecosystem productivity over Europe under past and future climate extremes
T. Kato, N. Viovy, N. Vuichard, P. Ciais
- P159 A compact instrument for measuring atmospheric CO₂ column densities at surface monitoring sites
N. Kobayashi, M. Kawasaki, T. Ibuki, et al.
- P160 Remote sensing of carbon dioxide to evaluate the carbon dioxide emission from forest/peat-land fires
G. Inoue, M. Kawasaki, M. Ohashi, et al.
- P161 Application of Carbon Tracking System based on ensemble Kalman filter for estimating the impact of nesting domain on carbon flux analysis in Asia
J. Kim, H. Kim, C. Cho
- P162 Belowground carbon status in vegetation restoration areas following landslide
C. Kim, J. Park, H. Ma, J. Jeong
- P163 Belowground carbon stocks of restored, un-restored and unburned forests in a fire-damaged landscape

- P164 **C. Kim**, J. Park, H. Ma, N. Ju
CO₂ exchange rates from tundra lichen, moss, and tussock, Council, Alaska
- P165 **Y. Kim**, N. Chae, S. Park, Y. Yoon
CO₂ exchange rates in Black Spruce Forest, Interior Alaska
- P166 **Y. Kim**, S. Kim
Monitoring and quantifying emissions of greenhouse gases in East Asia through in-situ measurements at Gosan station, Jeju Island, Korea
- P167 M.-K. Park, S. Li, S. Park, J. Kim, **K.-R. Kim**
Potential CO₂ efflux of CWD decomposition caused by tree species change under the climate change in Japan
- P168 **Y. Kominami**, N. Tanaka, M. Ataka, I. Tsuyama
Global scale model inter-comparison with GOSAT L4A and empirical upscaling based estimates of terrestrial biospheric variables
- P169 **M. Kondo**, K. Ichii
Predicting wetland extent, distribution and seasonality to estimate biological methane production in the Simple Biosphere Model
- P170 **P. Kraus**, S. Denning
The emissions of greenhouse gases from permafrost at the climate change
- P171 **V. Kudeyarov**, D. Zamolodchikov, E. Rivkina
Mesoscale modeling of atmospheric CO₂ over Denmark including exchange with coastal waters
- P172 **A. Lansoe**, C. Geels, M. Tum, et al.
Atmospheric Carbon Dioxide in Korea, 2012
- P173 **H.Y. Lee**, D. Min, S. Kim, D. Lee
Forest Floor Carbon Emissions from the Cloud Forests of Mt. Kinabalu, Malaysia
- P174 **J.K. Lee**, C. Yule
Combined CO₂ and O₂ measurements at the High Altitude Research Station Jungfrauoch, Switzerland
- P175 **M. Leuenberger**, I. van der Laan-Luijckx, S. van der laan, et al.
Energy, water vapor and CO₂ fluxes observed in two desert ecosystems with alkaline soil in Kazakhstan
- P176 **L. Li**, X. Chen, G. Luo
Modeling Interactions Between Carbon and Water in the Context of Climate Change in a Central Asian Arid Ecosystem: a Case Study in Xinjiang, China from 1981-2007
- P177 **C. Li**, C. Zhang, G. Luo, et al.
Elemental carbon emissions in Northern China: results from top-down constraints
- P178 J. Benmergui, **J. Lin**, L. Huang, et al.
Soil greenhouse gas fluxes from different forest types on Taihang Mountain, North China
- P179 **X.P. Liu**, W. Zhang, C.S. Hu
A high-resolution regional CO₂ assimilation system for estimating terrestrial sources and sinks in central Europe
- P180 **Y. Liu**, N. Gruber, D. Brunner, et al.
Removal of dissolved inorganic carbon and its mechanism in the Yellow River Estuary (YRE)
- P181 **Z. Liu**, L. Zhang, W. Cai, et al.
Estimating ecosystem carbon stock change in the conterminous United States from 1971 to 2010
- P182 **J.X. Liu**, Z. Zhu, B. Sleeter, et al.
Variation Characteristics and Sources of Greenhouse Gases in Urban Atmosphere
- P183 **W. Lv**, M. Liu
[Cancelled]
- P184 The impact of satellite data bias correction in carbon cycle data assimilation
- P185 **T. Maki**, T. Sekiyama, T. Miyoshi, et al.
Inverse modeling of the regional CO₂ fluxes for GOSAT CO₂ Level 4 product
- P186 **S. Maksyutov**, H. Takagi, T. Saeki, et al.
Radon flux map of Europe using terrestrial gamma radiation derived from soil radionuclides--a surrogate approach
- P187 **S. N. Manohar**, H.A.J. Meijer, M.A. Herber
Modeling of Carbon Dioxide emission from arctic sites
- P188 **Y. Mi**, K. van Huissteden, H. Dolman, et al.
On network design for the detection of urban greenhouse gas emissions: Results from the Indianapolis Flux Experiment (INFLUX)
- P189 **N. Miles**, M. Cambaliza, K. Davis, et al.
Diurnal and Synoptic Variability of Carbon Dioxide and Related Tracers in the Namib Desert
- P190 **E. Morgan**, J. Lavrič, C. Gerbig, et al.
Labile carbon retention in forest soils compensates for CO₂ released by priming
- P191 **Q. Na**, S. D. Allen, Y. KuzYakov
Development of Global Carbon Dioxide Distribution with On-line Tracer Transport Model in JMA
- P192 **T. Nakamura**, T. Maki, K. Yamada
Ocean surface CO₂ mapping and air-sea CO₂ flux estimate in the Pacific Ocean based on in-situ observations and neural statistics
- P193 **S. Nakaoka**, Y. Nojiri, S. Yasunaka, et al.
Estimates of Sources and Sinks of Carbon Dioxide for South Africa through Inverse Modelling of Atmospheric Measurements
- P194 **A. Nickless**, P. Rayner, R. Scholes, E. Brunke
Evaluation of the IRGASON Integrated CO₂/H₂O Gas Analyzer and Sonic Anemometer
- P195 **S. Oncley**, T. Horst, E. Swiatek, I. Bogoev
FENFLUX: The Short-term Climate Response of Carbon Dioxide, Methane and Water Fluxes from different Fens in East Anglia, United Kingdom
- P196 **G. Pan**, J. Kaduk, H. Balzter, et al.
Complementary constraints on Seasonal Carbon Exchange in Southern Amazonia Using GOSAT XCO₂ and Fluorescence
- P197 **N. Parazoo**, K. Bowman, C. Frankenberg, et al.
Global inversions of atmospheric CO₂ and CH₄: Fluxes for the Asia Regions
- P198 **P. Patra**, T. Nakazawa, K. Miyazaki, et al.
Integrating greenhouse gas emission processes into a dynamic global vegetation model of TRIPLEX-GHG
- P199 **C. Peng**, Q. Zhu, H. Chen
Reanalysis of trends in the northern hemisphere land biospheric carbon uptake period
- P200 **P. Pickers**, A. Manning
The Ocean Carbon & Biogeochemistry(OCB) Program
- P201 **H. Benway**, W. Cai
Uncertainty analysis of Eddy Covariance CO₂ flux measurements for a grassland site in North Rhine Westphalia, Germany
- P202 **H. Post**, H. Hendricks-Franssen, A. Graf, M. Schmidt, et al.
Variability of carbon fluxes in managed ecosystems of Europe- Does management override climate?
- P203 **C. Poepflau**, A. Freibauer, A. Don, H. Dolman
Land-ocean contrast of surface atmospheric CO₂ as revealed by observations from Bay of Bengal
- P204 **K. Ravi Kumar**
GPP estimates in a rotating crop using in situ and MODIS data
- P205 **M. L. Sánchez**, I. Pérez, N. Pardo, M. A. García
New constraint on the contemporary air-sea CO₂ flux using bottle carbon data
- P206 **T. Sasse**, B. McNeil, G. Abramowitz
Estimation of methane emission from rice paddy soils in Japan by using the biosphere model, BEAMS-C
- P207 **T. Sasai**, S. Nakai, K. Ono, et al.
The hotspots of high CH₄ and their relations with CO₂ in the surface seawater in the western Arctic Ocean

- P208 **D. Sasano**, M. Ishii, N. Kosugi, et al.
Inverse Modeling of CO₂ Fluxes Using GOSAT Data and Multi-year Ground-based Observations
- P209 **T. Saeki**, S. Maksyutov, M. Saito, et al.
First Detection of Volcanic CO₂ Signals from Space
- P210 **F. M. Schwandner**, S. A. Carn
From crops to boundary layer and back: the ARM/LBNL Carbon Project in the Southern Great Plains
- P211 M. Torn, **B. Sebastien**, M. Fischer, et al.
Contribution of the soil 14CO₂ to the atmosphere from the subtropical forest in South China
- P212 **C. Shen**, W. Yi, P. Ding, et al.
Continental sources and sinks intensify the steep seasonal and latitudinal gradient of atmospheric carbon dioxide over East Asia
- P213 **C. Shim**
Atmospheric Emissions of Greenhouse Gases from Different Nitrogen Sources
- P214 **K. Sistani**
Regional footprints and transport regimes for CO₂ measurement sites in New Zealand from backward Lagrangian dispersion modeling
- P215 **K. Steinkamp**, S. Mikaloff Fletcher, S. Moore
What Do We Need to Know about Monitoring the Atmosphere-Ecosystem Carbon Dioxide Exchange---From a Micrometeorologist's perspective
- P216 **J. Sun**
Robust Inversion of Carbon dioxide Fluxes over Temperate Asia in 2006-2008
- P217 **P. Swathi**, N. Indira, P. Rayner, et al.
- P218 **[Cancelled]**
- P219 **M. Teramoto**, Z. Tan, N. Liang
Flux estimates of CO₂ and CH₄ over East Asia using a Bayesian inversion with an optimal grid resolution
- P220 **R. Thompson**, A. Stohl
Terrestrial carbon balance in Tropical Asia: Contribution from land use and climatic changes
- P221 **B. Tao**, H. Tian, G. Chen, et al.
Assessing the Impact of Urban Form on Residential CO₂ Emission on a Neighborhood Scale in the Atlanta Metropolitan Area, USA
- P222 **J. Tu**
Eastern Boundary Upwelling Systems as sources and sinks of atmospheric CO₂: Insights from eddy-resolving modeling studies
- P223 **G. Turi**, Z. Lachkar, L. Kropuenske-Artman, N. Gruber
Inorganic carbon in Cumberland Sound on Baffin Island, eastern Canadian Arctic
- P224 **D. Turk**, S. Vagle, J. Bedard, et al.
Quantification of urban fossil fuel CO₂ emissions from the Indianapolis Flux Project (INFLUX)
- P225 **J. Turnbull**, M. Cambaliza, C. Sweeney, et al.
Investigation of the Biosphere with the Aid of Global Spatial Carbon Dioxide Cycle Model Taking into Account Seasonal Regime
- P226 **V. Usatyuk**, A.M. Tarko
CarbonTracker South America: a first comparison of model results with independent CO₂ observations
- P227 **I. van der Laan-Luijkx**, W. Peters, E. Gloor, et al.
Estimating continuous regional fossil fuel CO₂ concentrations in a densely populated area using CO₂, 13CO₂ and CO measurements
- P228 **S. N. Vardag**, S. Hammer, U. Karstens, et al.
Flux Footprint Estimation for Complex Surfaces
- P229 **T. Vesala**
National Carbon Footprint Accounts: Consumption, Displacements and a Decomposition Analysis of Changes between 2004 and 2007
- P230 **L.Y. Wan**, W. Cai, C. Wang
Terrestrial Ecosystem Carbon Flux as Inferred with New Ground CO₂ Observations in China
- P231 **H.M. Wang**
Refined Estimate of China's CO₂ Emissions: Provincial Inventory and Spatiotemporal Distributions
- P232 **H.K. Wang**
Global patterns of net primary production: a model-based analysis
- P233 **H. Wang**
Chemical weathering and CO₂ consumption in the Yellow River basin, emphasizing the origin of high HCO₃
- P234 **L. Wang**
Underestimation of chemical weathering in river basins, without considering human water consumption
- P235 **L. Wang**
Coupling of a biogeochemical model with a simultaneous heat and water model and its evaluation at a n Alpine meadow site
- P236 **X.F. Wang**
Investigating the atmospheric relationship between Carbonyl Sulfide and Carbon Dioxide using solar FTIR spectroscopy and a Chemical Transport Model
- P237 **Y.T. Wang**, M. Palm, N. Deutscher, et al.
Extensive Spread of Large Carbonate Accumulation in Arid Region of China
- P238 **X.J. Wang**
A Global Carbon Assimilation System Based on an Ensemble Dual Optimization Method
- P239 **Y. Wang**, Y. Li, J. Wang, et al.
Carbon balance of a winter wheat-summer maize double cropping system in the North China Plain
- P240 **Y. Y. Wang**, C.S. Hu, W.X. Dong
Air-sea CO₂ fluxes and saturation states in the Gulf of Mexico
- P241 **L. Barbero**, **R. Wanninkhof**, D. Pierrot
Five years of in situ atmospheric O₂ and CO₂ data from Weybourne Atmospheric Observatory, Norfolk, United Kingdom
- P242 **P. Wilson**, A. Manning, A. Avery, et al.
Mapping greenhouse gas emissions in the Los Angeles basin by remote sensing using a Fourier Transform Spectrometer on Mount Wilson
- P243 **K. Went**, D. Fu, E. Kort, S. Newman, et al.
The impacts of change in freezing-thawing dynamics on carbon release from foliar litter along an altitudinal gradient in the Alpine/subalpine forests in Eastern Qinghai-Tibet Plateau, China
- P244 **F. Wu**, J. Zhu, B. Tan, W. Yang, C. Peng
- P245 **[Cancelled]**
- P246 **X. Xia**, Z. Yang
Change of Soil Organic Carbon Stocks in Typical Regions of China
- P247 **M.G.Xu**, X. Zhang, W. Zhang, Y. Lou
Soil organic carbon sequestration potential on fertilized cropland: calculations from long-term experiments across China
- P248 **M.G.Xu**, J. Zhou, X. Wang, et al.
Widespread of soil organic carbon accumulation on fertilized cropland: evidence from long-term experiments across China
- P249 **M.G.Xu**, J. Zhou, X. Wang, et al.
Observation of increasing surface partial pressure of CO₂ in the Southeast Equatorial Indian Ocean, a region of CO₂ source
- P250 **L. Xue**, W. Yu, H. Wang
Capability of the Error Covariance Models in CO₂ Inverse Problems in Simultaneously Estimating Fossil Fuel Emissions and Biospheric Fluxes

- V. Yadav**, Y. Shiga, A. Michalak
P250 Do single-species and mixed forests differ in the maximum tree biomass they can support?
- Y. Yan**, I. Janssens, B. Gielen, et al.
P251 Potential atmospheric CO₂ reservoir from the ancient forests buried in Pearl River Delta, South China
- W. Yi**, C. Shen, P. Ding, et al.
P252 Uptake of anthropogenic CO₂ in the Australian sector of the Southern Ocean
G. Hashida, **H. Yoshikawa**, T. Okada, et al.
- P253 CO₂ dynamics of seawater in the seasonal ice zone
C. Nomura, **H. Yoshikawa**, S. Ichiro, S. Kobayashi, G. Hashida
- P254 Soil moisture modify temporal response of soil respiration to temperature in a desert shrub ecosystem: hysteresis and sensitivity
T.S. Zha
- P255 Stability of soil organic carbon (SOC) in three typical plantation forests in Beijing area, China
T.G. Zha, G. Sun, A. Noomets
- P256 Air-sea re-equilibration based upper ocean sink for anthropogenic CO₂
W. Zhai, H. Zhao
- P257 A new data assimilation approach for estimating surface carbon flux distribution
X. Zheng, S. Zhang, D. Bo, et al.
- P258 Carbon sequestration in conterminous U.S. forests based on climates, disturbances and stand age from AmeriFlux, inventory and remote sensing data
F.M. Zhang, J. Chen, Y. Pan, R. Birdsey
- P259 Evaluating spatial and temporal patterns of MODIS GPP over conterminous USA against flux measurements and a process model
F.M. Zhang, J. Chen, J. Chen, C. Gough, et al.
- P260 Reconciling estimates of regional gross primary productivity among top-down and bottom-up approaches for a tall-tower CO₂ concentration footprint area in central Saskatchewan, Canada
H. Zhang, B. Chen, D. Fu
- P261 Simulation of CO₂ concentration distributions in East Asia with RAMS-CMAQ
M. Zhang
- P262 Integrating Biome-BGC model with assimilated leaf area index to improve the accuracy of water and carbon flux simulations at Harvard Forest.
T.L. Zhang, C. Peng, Q. Zhu, et al.
- P263 Uncertainty in estimating the maximum light use efficiency of terrestrial ecosystems based on eddy flux and NPP observations
Q. Zhang, L. Zhang, H. He, et al.
- P264 Study on the Characteristics of CO₂ flux of Alpine Meadow Ecosystem in Tanggula Region of Qinghai-Tibetan Plateau
Y.H. Zhao, L. Zhao, E. Du, G. Liu, G. Yue
- P265 The relationship of gas transfer velocity with dissipation rate of turbulent kinetic energy dissipation rate and ocean waves
D.L. Zhao
- P266 A Global Carbon Assimilation System Based on a Dual Optimization Method
H. Zheng, Y. Li, J. Chen, et al.
- P267 A new method to evaluate regional-scale forest carbon sinks utilising traditional observation data
T. Zhou, P. Shi, G. Jia, Y. Luo
- P268 Fossil fuel derived CO₂ distribution across different regions of China estimated by radiocarbon (14C) analysis of annual plants
K. Liu, X. Xi, **L.P. Zhou**
- P269 Topsoil CO₂ flux in meadow steppe and planted forests with different stand ages estimated by radiocarbon analysis of soil organic carbon
L.P. Zhou, W. Tan, K. Liu, et al.
- P270 Estimating global fluxes of CO₂ for 2009-2010 using measurements from discrete air samples and space-borne (GOSAT) retrievals with empirical orthogonal functions
R. Zhuravlev, A. Ganshin, S. Maksyutov, et al.
- P271 Greenhouse Gas Network Design for Australia
T. Ziehn, R. Law, P.

Theme 3: Future of the carbon cycle: drivers, vulnerabilities, feedbacks and management options

- P272 Total Alkalinity Measurements in the Northern Arabian Gulf: Signals of Acidification
D. Al-Shamroukh
- P273 Eco-restoration and development of silvopastoral systems: the potential land use options for carbon sequestration
R. Bhatt, P. Kumar, M. Roy
- P274 A Carbon Intensity and Production Allowance System for ETS: Bringing Merit Order in Chinese Power Sector
B. Denjean, **C. Cassisa**
- P275 The observed climate change and its future scenarios simulated with ECHAM model at various CO₂ emission in China
Y. Chen
- P276 The impact of biogeochemical processes on the calcium carbonate saturation state in a Circumpolar Flow Lead in the western Arctic
M. Chierici, A. Fransson, L. Miller, et al.
- P277 Significance of metrology in global ecological monitoring
Y. Chu
- P278 CO₂ Activation and Conversion Catalysed by FeS Nano-Catalyst
N. Dzade, A. Roldan, N. de Leeuw
- P279 An atmospheric baseline station for monitoring geological storage of carbon dioxide (CCS): Sensitivity of detection for simulated CO₂ leaks
A. Feitz, H. Berko, D. Etheridge, Z. Loh
- P280 Near-surface detection of CO₂ leakage using eddy covariance techniques at the Ginninderra CO₂ controlled release facility
I. Schroder, **A. Feitz**, T. Kuske, et al.
- P281 Atmospheric tomography as a tool for quantification of CO₂ emissions from potential surface leaks
T. Kuske, C. Jenkins, **A. Feitz**, S. Zegelin
- P282 Observed trends of carbon storage, acidification and calcium carbonate saturation along the OVIDE section
M. I. Garcia-Ibanez, A.F. Rios, M. Herle, F.F. Perez
- P283 North Atlantic variability of oceanic CO₂ uptake in response to simulated past, present and future climate change
N. Goris, C. Heinze, J. Tjiputra, J. Schwinger
- P284 CO₂ concentration-carbon feedback of terrestrial ecosystems in CMIP ESMs
T. Hajima, K. Tachiiri, A. Ito, M. Kawamiya
- P285 The Causes and Implications of Persistent Atmospheric Carbon Dioxide Biases in Earth System Models
F. Hoffman, J. Randerson
- P286 Temperature dependence of seawater pH —An experimental study
Y. Hu
- P287 The climate change in Central Asia from 1979-2011 based on multiple datasets
Z.Y. Hu, C. Zhang
- P288 Solving CO₂ by planting forests in Australia
A. Hughes
- P289 Response of soil organic matter decomposition to experimental warming in a cultivated Andisol in Japan
A. W. Kishimoto-Mo, S. Yonemura, M. Kondo, Y. Shirato,

- et al.
- P290 Spatial and temporal variability of ocean acidification in the interior western North Pacific
N. Kosugi, D. Sasano, M. Ishii, et al.
- P291 Changes in carbon sequestration and soil organic matter stability induced by cropland withdrawal in Russia after 1990
L. de Gerenyu V., **I. Kurganova**, Y. Kuzyakov
- P292 Constraints on CO₂ emissions from burning fossil fuels to 2050
C. Le Quéré, P. Canadell, G. Peters, et al.
- P293 Predicting the effect of elevated CO₂ on NPP using a global coupled C, N and P model
L.H. Li
- P294 Internal- and intra-model variability in CMIP5 interactive carbon cycle projections of fossil fuel CO₂ invasion into the ocean
H.M. Li, T. Ilyina, K. Six, et al.
- P295 Response and Feedback of Soil Carbon Emission to Global Warming in East Asian Region
N. Liang, K. Takagi, Y. Zhang, et al.
- P296 Spatial and Temporal Evolution of Carbon Storage in Terrestrial Ecosystems in the United States from 2000 to 2050
S.G. Liu
- P297 The pH boundary layer over corals
W. McGillis, T. Martz
- P298 Atmospheric CO₂ and O₂ monitoring in connection with subsurface CO₂ storage
C. van Leeuwen, **Harro A.J. Meijer**
- P299 The impact of photosynthesis, calcification and water circulation on carbon chemistry variability above a coral reef: a modelling study.
M. Mongin, M. Baird, B. Tilbrook
- P300 Spatial variability of surface pCO₂ in the Amundsen Sea polynya, Antarctica
L. Mu, P. Yager
- P301 Environmental controls of terrestrial carbon fluxes over Europe based on CMIP5 model estimates
S. Mystakidis, E. Davin, N. Gruber, S. Seneviratne
- P302 Perturbation of sea-to-air DMS flux in Polar Regions and the impact on contemporary climate
B. Qu, A. Gabric, L. Rotstayn
- P303 Climate Change Scenarios over Bangladesh using a high resolution AGCM
M. Rahman, M. Rafi Uddin
- P304 Carbon Dioxide Emission and Carbon Sequestration under Different Tillage and Rice Straw Management in Soil
M. Rahman, G. K. M. Rahman, M. Kashem, et al.
- P305 Role of modern and intermediate waters in future ocean acidification: analysis of CMIP5 models
L. Resplandy, L. Bopp, J. Orr, J. Dunne
- P306 Nonlinearity of ocean carbon feedbacks in CMIP5 models
J. Schwinger, J. Tjiputra, C. Heinze, et al.
- P307 Amplified global warming induced by ocean acidification? New climate aspects of the marine sulfur cycle
K. Six, S. Kloster, T. Ilyina, et al.
- P308 Estimation of CO₂ absorbing potential in Korean deciduous forests using KFSC model
J. Lee, C. Park..., Y.W. Son
- P309 Meta-analysis reveals profound responses of plant traits to glacial CO₂ levels
A. Temme
- P310 A comparative study of inorganic carbon speciation and fluxes in the Congo and Mackenzie Rivers
Z.A. Wang, H. Katherine, M. Paul, et al.
- P311 The implications of additional Carbon Cycle processes in the HadGEM2-ES Earth System Model.
A. Wiltshire
- P312 Changes in Coupled Water-Carbon Cycles in Contiguous US through the 21st Century
J. Xiong, W. Wang, H. Hashimoto, R. Nemani
- P313 Evaluating drought conditions on the carbon cycle dynamics in contiguous United States on projecting CMIP5 dataset
J. Xiong, W. Wang, H. Hashimoto, R. Nemani
- P314 Modelling organic carbon stocks in croplands of China under different agricultural management and climate change scenarios
Y.Q. Yu
- P315 Carbon sequestration via wood harvest and storage: A n assessment of its harvest potential
N. Zeng, T. King, B. Zaitchik, et al.
- P316 A Process-Based Dryland Ecosystem Model for Central Asia
C. Zhang, C. Li, G. Luo, X. Chen
- P317 **[Cancelled]**
- P318 Aerosol Corruption Effect on Satellite-Based Estimation of Gross Primary Production during Drought Period
Y. Zhang, C. Peng, Q. Zhu, H. Chen
- P319 Responses of forest productivity and carbon storage to climate change in the southern China
M.F. Zhao, W. Xiang, C. Peng, et al.
- P320 pH Sensor Drift Characteristic Analysis in Ocean Acidification monitoring
Y.M. Zhao, H. Si, Z. Li, et al.
- P321 Estimating Carbon Sequestration Capacities in Biologic and Geologic Reservoirs in the United States
Z.L. Zhu, P. Warwick
- P322 Modelling the Carbon Cycle in the Australian Climate and Earth System Simulator
R. Law, T. Ziehn, R. Matear, et al.

Spectronus

FTIR Trace Gas & Isotope Analyser

FTIR 多要素温室气体在线分析仪

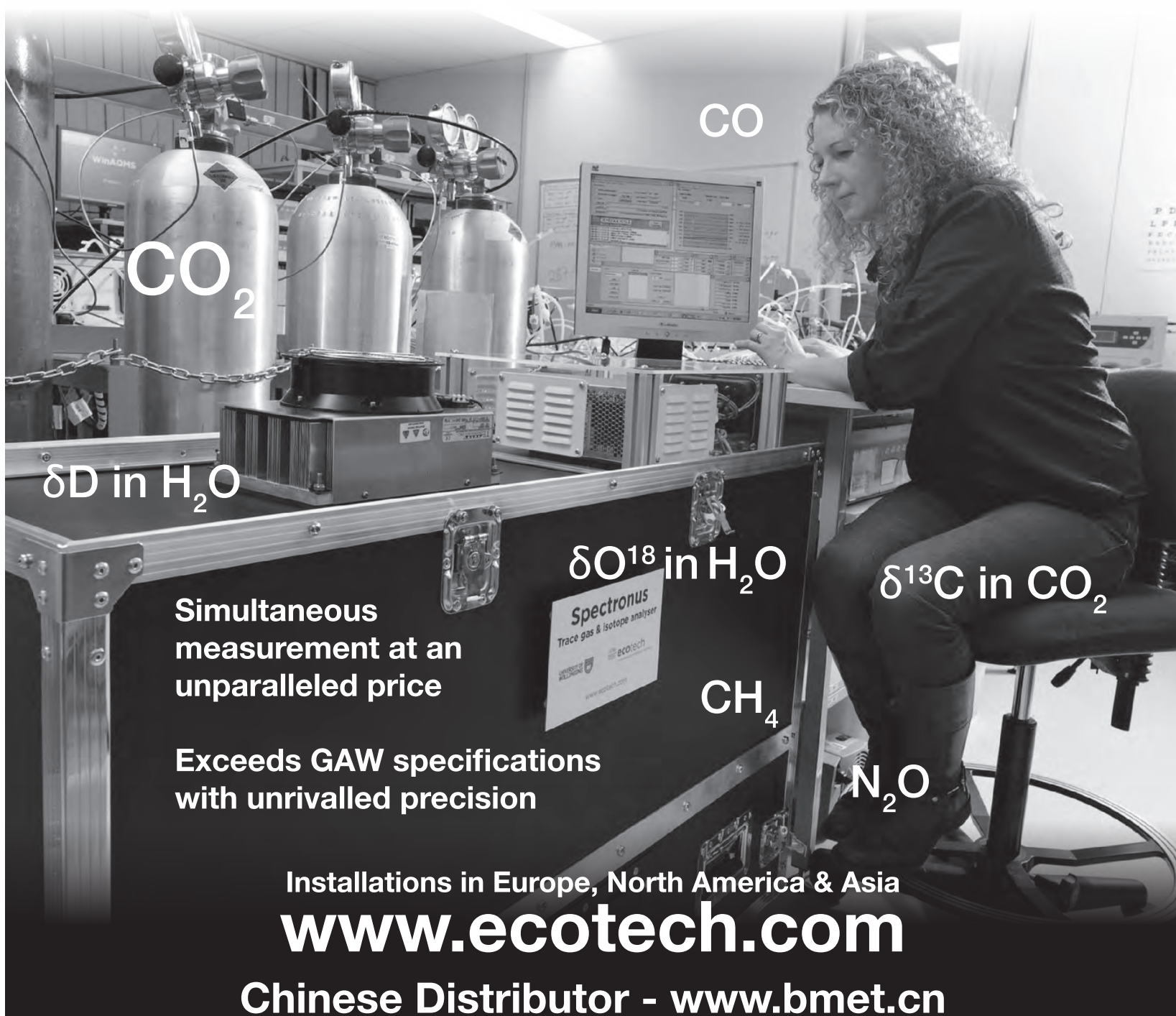

CO_2

CO

δD in H_2O

δO^{18} in H_2O

$\delta^{13}\text{C}$ in CO_2

CH_4

N_2O

Simultaneous measurement at an unparalleled price

Exceeds GAW specifications with unrivalled precision

Installations in Europe, North America & Asia

www.ecotech.com

Chinese Distributor - www.bmet.cn

Spectronus
Trace gas & isotope analyser
ecotech
www.ecotech.com

EXHIBITION

Hall 4, 1st Floor, BICC

1- LI-COR Biosciences

www.licor.com/env

Phone: +1-402-467-3576

Fax: +1-42-467-2819

Email: envsales@licor.com

LI-COR Biosciences is a leading manufacturer of instrumentation for the environmental sciences. LI-COR's product lines include: light measurement instrumentation, gas analyzers for CO₂, H₂O, and CH₄, a complete eddy covariance system for measuring atmospheric gas flux, a portable photosynthesis system, a soil CO₂ flux system, an leaf area measurement instrumentation. LI-COR sells and supports instruments worldwide through our offices in the United States, Germany, United Kingdom, and through a network of distributors.

2- 北京力高泰科技有限公司/基因有限公司农业环境科学部

北京西城区西直门南大街2号成铭大厦A座22F

邮编: 100035

电话: 010-51665551

传真: 010-66001652

网址: <http://www.ecotek.com.cn>

Email: info@ecotek.com.cn

北京力高泰科技有限公司(基因有限公司农业环境科学部)主要代理农林业、生态、环境等领域的国际先进科研仪器,为国内科研单位提供售后服务。公司多年代理美国 LI-COR 公司、Dynamax 公司、Decagon 公司和英国 Technologica 公司的产品,2013 年新代理了加拿大 Aurora 公司的部分产品。公司秉承“让专才为专家服务/LET PROFESSIONALS SERVE PROFESSIONALS”的一贯宗旨,高品质产品、高素质团队和高质量服务一直是我们的努力方向。

3- Ecotech Pty Ltd

Head Office – Victoria

1492 Ferntree Gully Road, Knoxfield, Vic 3180

Ph: (03) 9730 7800 Fax: (03) 9730 7899 Ext: 1300

Email: ecotech@ecotech.com.au

Website: www.ecotech.com.au

For more than 35 years, Ecotech Pty Ltd, has built a reputation for reliability and accuracy in environmental monitoring. Ecotech offers a one-stop shop for monitoring ambient air. Ecotech is engaged in the ongoing development of new gas analyser technologies and recently released the Spectronus trace gas and isotope analyser in collaboration with the University of Wollongong. The Spectronus combines a Fourier Transform Infrared (FTIR) spectrometer, multi-pass gas sample cell and a high performance detector with sophisticated software for fully automated operation and real-time quantitative analysis of CO₂, δ¹³C in CO₂, CO, CH₄, δD-H₂O, δ¹⁸O in H₂O, N₂O and N₂O isotopologues. It exceeds GAW requirements providing high repeatability and excellent reproducibility for multiple gas species simultaneously without the need for frequent gas calibrations. A non-portable manifold completes the package.

4- Advances in Atmospheric Sciences (AAS)

Bimonthly

Launched in 1984

2011 Impact Factor (Journal Citation Reports): 0.987

<http://www.iapjournals.ac.cn/aas>

AAS is an international journal on the dynamics, physics, and chemistry of the atmosphere and oceans. It covers the latest achievements and developments in the atmospheric sciences, including marine meteorology and geophysics, as well as the theoretical and applied areas of these disciplines. In 2008, ScienceWatch.com named AAS as a “rising star” in the geosciences journals. In 2009, AAS was included in SCI. Springer Market Intelligence & Web Analytics reported that in 2012 there were 26,547 full-text article downloads from the Springer website.

Atmospheric and Oceanic Science Letters (AOSL)

Bimonthly

Launched in 2008

<http://www.iapjournals.ac.cn/aosl>

AOSL is an international journal for the publication (in English) of original Letters related to all aspects of the atmospheric sciences and physical oceanography. The journal provides a rigorous peer-review process, rapid publication speeds (final decision in three months, and publication in six months), and maintains high standards in the quality of accepted manuscripts.

5- meisei electric co., ltd.

TEL: 81-3-3814-5129

FAX: 81-3-3814-5004

URL: <http://www.meisei.co.jp/english/>

Email: maedar@meisei.co.jp

Meisei presents a radiosonde to measure vertical CO₂ distribution and a CO₂ column densitometer by using an optical fiber etalon.

6- Campbell Scientific Inc.

Yujin Wen; Emily Fu

email: ywen@campbellsci.com (Y. Wen) or

Emily.fu@campbellsci.com.cn (E. Fu)

Tel: 1 (435) 227-9140 (International); 6(139)1002-7296 (China)

Fax: 1 (435) 227-9091 (International)

www.campbellsci.com

Campbell Scientific, Incorporation (CSI) is a leading manufacturer of environmental data acquisition instrumentation. CSI supports applications in a variety of disciplines including meteorology, agriculture, forestry, ecology, hydrology, and geo-sciences. CSI's instrumentation features unmatched reliability, measurement precision, flexibility, and portable, low-powered operation in severe environments in various ecosystems. Over 30 years ago CSI began developing eddy covariance measurement systems. CSI continues this legacy today with a new line of micrometeorological instruments implementing the need of cutting edge research. The newest CPEC200 Closed Path Eddy Covariance System has greatly improved frequency response compared to traditional closed-path systems. The patented IRGASON is a fully integrated and collocated open-path gas analyzer and sonic anemometer, being able to minimize

frequency loss in eddy covariance measurements. The innovative AP200 Atmospheric Profile System is designed to measure and calculate CO₂/H₂O storage terms. These landmark products provide more accurate measurements of net ecosystem exchange of CO₂ and water.

7- PICARRO INC.

www.picarro.com
contact person: Pao-hui Wang
email: paohui@focusventures.com
Tel: 13488629642, 010-65815186
Fax: 010-65815186

由于全球碳，水和氮循环混乱的原因，一个全球性的经济和环境转变正在进行中--基本上对地球上所有生命造成了影响。Picarro 的客户通过使用精密的科学仪器理解这些复杂的环境变化进行极其精确的科学测量，他们遍布在全球 60 多个国家和七大洲，在世界上最恶

劣的环境中，从格陵兰岛到亚马逊。在世界各地，他们打破了难以想象科学发现的障碍。我们的技术：光腔衰荡光谱（CRDS）可在十亿分之一的分辨率下侦测分子，随时随地实时测量和追踪整个环境循环。

8- 北京华益瑞科技有限公司

办公地址：北京市海淀区复兴路甲38号嘉德公寓821—823室，邮编：100039

电 话：010-88202236
传 真：010-88202336
邮 箱：sales@truwel.com

北京华益瑞科技有限公司自成立以来一直致力于生态环境，气象水文，结构监测，工业数据采集控制的系统集成以及设备研发。在过去的几年中，我们先后为中国生态系统研究网络 CERN 组织，CFERN 网络和科技部 973 项目提供监测设备，全面参与了中国通量网 China Flux 项目的建设，同时与以下单位保持密切的合作：中国科学院，中国林科院，中国农科院，中国气象局，国家海洋局，清华大学，同济大学等国家重点高校及其它研究所等。

LIST OF PARTICIPANTS

1. **Agusti-Panareda, Anna**
ECMWF, United Kingdom
2. **Ahmed, Kawser**
Dhaka University, Bangladesh
3. **Alden, Caroline**
INSTAAR / University of Colorado
Boulder, USA
4. **Alexandrov, Georgii**
A.M. Obukhov Institute of
Atmospheric Physics of Russian
Academy of Sciences, Russian Fed
5. **Al-Shamroukh, Dalal**
Kuwait Institute for Scientific
Research, Kuwait
6. **Anders, Robert**
Oak Ridge National Lab, USA
7. **Aoki, Shuji**
Tohoku University, Japan
8. **Aryal, Deb Raj**
El Colegio de la Frontera Sur
(ECOSUR), Mexico, Mexico
9. **Asanuma, Tatsuhiko**
Meisei Electric co. Ltd., Japan
10. **ataka, mioko**
kyoto university, Japan
11. **Badawy, Bakr**
Environment Canada, Canada
12. **Baker, David**
Colorado State University, USA
13. **Baker, Ian**
Colorado State University, USA
14. **Bakker, Dorothee**
School of Environmental Sciences,
University of East Anglia, United
Kingdom
15. **Balbinot, Rafaelo**
Federal University of Santa Maria -
Brazil, Brazil
16. **Ballav, Srabanti**
Jadavpur University, India
17. **Bao, Ying**
the First Institute of Oceanography,
SOA, China
18. **Bartlett, Paul**
Environment Canada, Canada
19. **Basso, Luana**
Instituto de Pesquisas Energéticas e
Nucleares - IPEN, Brazil
20. **Basu, Sourish**
SRON Netherlands Institute for
Space Research, Netherlands
21. **Becker, Meike**
GEOMAR Helmholtz Centre for
Ocean Research Kiel, Germany
22. **Belikov, Dmitry**
National Institute for Environmental
Studies, Japan
23. **Bellerby, Richard**
Norwegian Institute for Water
Research, Norway
24. **Bergamaschi, Peter**
European Commission Joint
Research Centre, Italy
25. **Berridge, Callum**
Vrije Universiteit Amsterdam,
Netherlands
26. **Bhatt, Ram Krishna**
Central Arid Zone Research Institute
(ICAR), India
27. **Bopp, Laurent**
LSCE / IPSL, France
28. **Bovensmann, Heinrich**
Institute of Environmental Physics,
University of Bremen, Germany
29. **Brailsford, Gordon**
NIWA, New Zealand
30. **Broquet, Gregoire**
LSCE, France
31. **Brown, Peter**
University of East Anglia, Norwich,
United Kingdom
32. **Bruhwieler, Lori**
NOAA Earth System Research
Laboratory, USA
33. **Brunke, Ernst-Günther**
South African Weather Service,
South Africa
34. **Buermann, Wolfgang**
Institute for Climate and Atmospheric
Science, University of Leeds, United
Kingdom
35. **Buschmann, Matthias**
IUP University of Bremen, Germany
36. **Cai, Wei-Jun**
University of Delaware, USA
37. **Canadell, Pep**
CSIRO, Australia
38. **Cao, Longhui**
ZheJiang University, China
39. **Carvalho, Nuno**
Max Planck Institute for
Biogeochemistry, Germany
40. **Cassisa, Cyril**
Institute of Energy, Environment and
Economy, China
41. **Chatterjee, Abhishek**
National Center for Atmospheric
Research, USA
42. **Chen, Baozhang**
Institute of Geographic Sciences and
Natural Resources Research, CAS,
China
43. **Chen, Huilin**
University of Groningen
&NOAA/ESRL, USA
44. **Chen, Jing**
University of Toronto, Canada
45. **Chen, Min-Te**
National Taiwan Ocean University
46. **Chen, Tiexi**
Nanjing University, China
47. **Chen, Yaoliang**
xinjiang institute of ecology and
geography, chinese academy of
science, China
48. **Chen, Youmin**
Henan University, China
49. **Chen, Zhaohui**
IAP, China
50. **Chevallier, Chevallier**
LSCE, France
51. **Chierici, Melissa**
Institute of Marine Research,
Norway
52. **Chu, Ying**
National Institute of Metrology, China
53. **Ciais, Philippe**
LSCE, France
54. **Clement, Dominic**
ETH Zurich, Switzerland
55. **Colm, Sweeney**
NOAA, USA
56. **Combe, Marie**
Wageningen University, Netherlands
57. **Cresto Aleina, Fabio**
Max Planck Institute for Meteorology,
Germany
58. **Dai, Minhan**
State Key Laboratory of Marine
Environmental Science (Xiamen
University), China
59. **Davis, Ken**
PSU, USA
60. **De Brito, Alan**
National Institute for Space
Research, Brazil
61. **Deng, Feng**
University of Toronto, Canada
62. **Denning, Scott**
Colorado State University, USA
63. **Deutscher, Nicholas**
University of Bremen, Germany
64. **Ding, Ping**
Guangzhou Institute of
Geochemistry, Chinese Academy of
Sciences, China
65. **Dolman, Han**
Vu University Amsterdam,
Netherlands
66. **Du, Enzai**
Peking University, China
67. **Du, Xin**
Nankai University, China
68. **Dyukarev, Egor**
Institute of Monitoring of Climatic
and Ecological Systems SB RAS,
Russian Fed
69. **Dzade, Nelson**
University College London, UK
70. **Ekoungoulou, Romeo**
Beijing Forestry University, China
71. **Evans, Gavin**
University of Southampton, United
Kingdom
72. **Fang, Yuanyuan**
Carnegie Institution for Science,
USA
73. **Fanin, Thierry**
Vrije University, Netherlands
74. **Fay, Amanda**
University of Wisconsin-Madison,
USA
75. **Feitz, Andrew**
Geoscience Australia, Australia
76. **Feng, Xiaojuan**
Institute of Botany, CAS, China
77. **Fernandez, Irene**
IIAG/CSIC, Spain

- 78. Flecha Saura, Susana**
Instituto de Ciencias Marinas de Andalucía (CSIC), Puerto Real, Cádiz, Spain., Spain
- 79. Fransson, Agneta**
Norwegian Polar Institute, Norway
- 80. Freibauer, Annette**
Thuenen-Institute of Climate-Smart Agriculture, Germany
- 81. Froelicher, Thomas**
Princeton University, USA
- 82. Fu, Jia**
Campbell Scientific Inc., USA
- 83. Fu, yongshuo**
University of Antwerp; Peking university, Belgium
- 84. Ganshin, Alexander**
Central Aerological Observatory, Russian Fed
- 85. Garcia Ibanez, Maria Isabel**
Institute Investigaciones Marinas (CSIC), Spain
- 86. Gatti, Luciana**
IPEN, Brazil
- 87. Geels, Camilla**
Aarhus University, Denmark
- 88. Golovatskaya, Evgeniya**
IMCES SB RAS, Russian Fed
- 89. Gonzalez Alonso, Federico**
CIFOR-INIA, Spain
- 90. Goris, Nadine**
Geophysical Institute at the University of Bergen & Bjerknes Centre for Climate Research, Bergen, Norway
- 91. Goto, Daisuke**
National Institute of Polar Research, Japan
- 92. Graven, Heather**
Scripps Institution of Oceanography, USA
- 93. Gregor, Luke**
University of Cape Town, South Africa
- 94. Griffith, David**
University of Wollongong, Australia
- 95. Gruber, Nicolas**
ETH Zurich, Switzerland
- 96. Guo, Zhengtang**
Institute of Geology and Geophysics, Chinese Academy of Science, China
- 97. Gusti, Mykola**
International Institute for Applied Systems Analysis / Lviv Polytechnic National University, Austria
- 98. Hajima, Tomohiro**
Japan Agency for Marine-Earth Science and Technology, Japan
- 99. Han, Ching Chun**
Picarro Beijing Representative Office, China
- 100. Han, Qifei**
Xinjiang Institute of Ecology and Geography, CAS, China
- 101. Hankin, Steve**
NOAA/PMEL, USA
- 102. Harasawa, Sumiko**
National Institute for Environmental Studies, Japan
- 103. Heimann, Martin**
Max-Planck-Institute for Biogeochemistry, Jena, Germany
- 104. Heinze, Christoph**
University of Bergen, Geophysical Institute and Bjerknes Centre, Norway
- 105. Heinze, Mathias**
Max Planck Institute for Meteorology, Germany
- 106. Hoffman, Forrest**
Oak Ridge National Laboratory, USA
- 107. Hoffmann, Friederike**
University of Bergen, Norway
- 108. Hong, Jiyoun**
Korea Environment Institute, South Korea
- 109. Hong, Wu**
Institute of Geographic Sciences and Natural Resources Research (IGSNRR), Chinese Academy of Sciences (CAS), China
- 110. Hoppema, Mario**
Alfred Wegener Institute Helmholtz Centre for Polar and Marine Research, Germany
- 111. House, Joanna**
Cabot Institute, Bristol University, United Kingdom
- 112. Houweling, Sander**
SRON/IMAU, Netherlands
- 113. Hsieh, Chengi**
National Taiwan University
- 114. Hu, Xinpeng**
Texas A&M University - Corpus Christi, USA
- 115. Hu, Yubin**
Alfred Wegener Institute, Germany
- 116. Hu, Zengyun**
Xinjiang Institute of Ecology and Geography, Chinese Academy of Sciences, China
- 117. Huang, Mei**
Institute of geographical sciences and nature resources research, China
- 118. Huang, Qing**
Beijing Normal University, China
- 119. Huang, Xiaoxian**
Nanjing University, China
- 120. Huertas, I. Emma**
CSIC, Spain
- 121. Hughes, Arthur**
CO2 Capture Corporation, USA
- 122. Hungate, Bruce**
Northern Arizona University, USA
- 123. Hutjes, Ronald**
Wageningen University, Netherlands
- 124. Ichii, Kazuhito**
Fukushima University, Japan
- 125. Iida, Yosuke**
Japan Meteorological Agency, Japan
- 126. Indira, Nuggehalli**
C-MMACS, India
- 127. Inoue, Gen**
University of Tokyo, Japan
- 128. Ishidoya, Shigeyuki**
National Institute of Advanced Industrial Science and Technology (AIST), Japan
- 129. Ishii, Masao**
Meteorological Research Institute, Japan
- 130. Ishizawa, Misa**
National Institute for Environmental Studies, Japan
- 131. Jaervi, Leena**
University of Helsinki, Finland
- 132. Jain, Atul**
University of Illinois, USA
- 133. Janardanan Achari, Rajesh**
Center for Global Environmental Research, National Institute for Environmental Studies, Tsukuba, Japan, Japan
- 134. Jeong, Jaeyeob**
UNIVERSITY OF SOUTH AUSTRALIA, South Korea
- 135. Jeremy, Mathis**
NOAA - PMEL, USA
- 136. Jia, Binghao**
LASG, Institute of Atmospheric Physics, Chinese Academy of Sciences, China
- 137. Jia, Xin**
Beijing Forestry University, China
- 138. Jiang, Chuangye**
Shanxi Province Climate Center, China
- 139. Jiang, Fei**
International Institute for Earth System Science, Nanjing University, China
- 140. Jiang, Qian**
Institute of Geography, University of Hamburg, Germany
- 141. Jiang, Yongkai**
Tsinghua University, China
- 142. Jiao, Nianzhi**
Xiamen University, China
- 143. Johnson, Mark**
LI-COR BIOSCIENCES, USA
- 144. Jones, Dylan**
University of Toronto, Canada
- 145. Jones, Steve**
University of East Anglia, United Kingdom
- 146. Ju, Weimin**
Nanjing University, China
- 147. Kang, Ji-Sun**
KIAPS, South Korea
- 148. Karstens, Ute**
Max-Planck-Institute for Biogeochemistry, Germany
- 149. Kato, Tomomichi**
LSCE, CEA-CNRS-UVSQ, France
- 150. Kauppi, Pekka**
University of Helsinki, Finland
- 151. Kawamiya, Michio**
JAMSTEC, Japan
- 152. Kawasaki, Masahiro**
Research Institute for Humanity and Nature, Japan
- 153. Keeling, Ralph**
Scripps Institution of Oceanography, USA
- 154. Kentarchos, Anastasios**
European Commission, Belgium
- 155. Keppel-Aleks, Gretchen**
University of California, Irvine, USA
- 156. Kim, Choosig**

- Department of Forest Resources,
Gyeongnam National University of
Science and Technology, South
Korea
157. Kim, Hyun Mee
Yonsei University, South Korea
158. Kim, JinWoong
Yonsei University, South Korea
159. Kim, Joon
Seoul National University, South
Korea
160. Kim, Kyung-Ryul
Seoul National University, South
Korea
161. Kim, Yongwon
University of Alaska Fairbanks, USA
162. Kishimoto, Ayaka
National Institute for
Agro-Environmental Sciences,
Japan
163. Ko, Ginger Wai Kuen
The University of Hong Kong,
HongKong SAR, China
164. Koertzing, Arne
GEOMAR, Germany
165. Kominami, Yuji
Forestry and forest products
research institute, Japan
166. Kondo, Masayuki
Fukushima University, Japan
167. Kosugi, Naohiro
Meteorological Research Institute,
Japan
168. KOULIKOV, SERGUEI
LI-COR BIOSCIENCES, USA
169. Kozlova, Elena
University of East Anglia, United
Kingdom
170. Kozyr, Alexander
Oak Ridge National Laboratory, USA
171. Kraus, Parker
Colorado State University, USA
172. Kuddeyarov, Valery
Institute of Phys-Chem & Biol
Problems in Soil Science of RAS,
Russian Fed
173. Kunz, Martin
Max Planck Institute for
Biogeochemistry, Germany
174. Kurganova, Irina
Institute of Physicochemical and
Biological Problems in Soil Science,
Russian Academy of Sciences,
Russian Fed
175. Kurz, Werner
Natural Resources Canada, Canada
176. Kuske, Tehani
Geoscience Australia, Australia
177. Labuschagne, Casper
South African Weather service,
South Africa
178. Landschützer, Peter
University of East Anglia, United
Kingdom
179. Lansoe, Anne Sofie
Department of Environmental
Science, Aarhus University,
Denmark
180. Laruelle, Goulven
Université Libre de Bruxelles,
Belgium
181. Lauerwald, Ronny
Université Libre de Bruxelles,
Belgium
182. Lauvaux, Thomas
PennState University, USA
183. Lauvset, Siv Kari
University of Bergen, Norway
184. Lavric, Jost Valentin
Max Planck Institute for
Biogeochemistry, Germany
185. Le Quére, Corinne
Tyndall Centre for Climate Change
Research, University of East Anglia,
United Kingdom
186. Lee, Haeyoung
Korea Meteorological Administration,
South Korea
187. Lee, Jo Kien
Monash University, Malaysia
188. Legge, Oliver
University of East Anglia, United
Kingdom
189. Lenton, Andrew
CSIRO Marine and Atmospheric
Research, Australia
190. Leuenberger, Markus
Physics Institute, University of Bern,
Switzerland
191. Levy, Marina
LOCEAN, France
192. Li, Chaofan
Xinjiang Institute of Ecology and
Geography of Chinese Academy of
Sciences, China
193. Li, Hongmei
Max-Planck Institute for Meteorology,
Germany
194. Li, Longhui
University of Technology, Sydney,
Australia
195. Li, Weiping
National Climate Center, China
Meteorological Administration, China
196. Li, Yangchun
IAP, China
197. Liang, Naishen
National Institute for Environmental
Studies, Japan
198. Liang, Xiaoping
tianjin polytechnic university, China
199. Lin, Guanghui
Tsinghua University, China
200. Lin, John
University of Utah, USA
201. Lindroth, Anders
Lund University, Sweden
202. Liu, Jinxun
SGT Inc, -
203. Liu, Li
Dalian Institute of Chemical Physics,
CAS, China
204. Liu, Miaomiao
Nanjing University, China
205. Liu, Ronggao
IGSNRR, Chinese Academy of
Sciences, China
206. Liu, Shuguang
US Geological Survey, USA
207. Liu, Xiuping
Institute of Genetics and
Developmental Biology, CAS, China
208. Liu, Yangchun
China
209. Liu, Yu
ETH, China
210. Liu, Zhiyuan
Ocean University of China, China
211. Lo Monaco, Claire
LOCEAN-IPSL, France
212. Lohrenz, Steven
University of Massachusetts
Dartmouth, USA
213. Lopez, Morgan
CEA-LSCE, France
214. Lu, Daren
Institute of Atmospheric Sciences,
IAP, China
215. Lu, Lixin
Colorado State University, USA
216. Luo, Geping
Xinjiang Institute of Ecology and
Gepgraphy, CAS, China
217. Luo, Yiqi
University of Oklahoma, USA
218. Lv, Weiwei
Wuhan Regional Climate Center,
China
219. Ma, Chun
Tianjin Research Institute for Water
Transport Engineering, Ministry of
Transport, China
220. Ma, Jie
Xinjiang Institute of Ecology and
Geography, CAS, China
221. MacBean, Natasha
Laboratoire des Sciences du Climat
et de l, France
222. Machida, Toshinobu
National Institute for Environmental
Studies, Japan
223. Maki, Takashi
Meteorological Research Institute,
Japan
224. Maksyutov, Shamil
NIES, Japan
225. Manizza, Manfredi
Scripps Institution of Oceanography,
USA
226. Manning, Andrew
University of East Anglia, United
Kingdom
227. Manohar, S.N.
University of Groningen,
Netherlands
228. Martin, Georg
Estonian Marine Institute, University
of Tartu, Estonia
229. Masarie, Ken
NOAA ESRL, USA
230. Matsueda, Hidekazu
Meteorological Research Institute,
Japan
231. Matsumi, Yutaka
Nagoya University, Japan
232. Mauricio, Espinoza
Universidad Austral de Chile, Chile
233. McGillis, Wade
Columbia University, USA
234. McKinley, Galen

- University of Wisconsin - Madison, USA
235. McNeil, Ben
 University of New South Wales, Australia
236. Meijer, Harro A.J.
 Univeristy of Groningen, Netherlands
237. Mi, Yanjiao
 Free University Amsterdam, Netherlands
238. Mikaloff Fletcher, Sara
 National Institute of Water and Atmospheric Research, New Zealand
239. Miles, Natasha
 The Pennsylvania State University, USA
240. Miller, John
 NOAA, USA
241. Miller, William
 LI-COR BIOSCIENCES, USA
242. Min, Deullae
 Korea Meteorological Administration, South Korea
243. Miranda, Jussara
 FEDERAL UNIVERSITY OF RIO DE JANEIRO, Brazil
244. Mongin, Mathieu
 CSIRO, Australia
245. Moore, Berrien
 University of Oklahoma, USA
246. Morgan, Eric
 Max Planck Institute for Biogeochemistry, Germany
247. Moriarty, Roisin
 UEA, United Kingdom
248. Morimoto, Shinji
 National Institute of Polar Research, Japan
249. Mu, Linquan
 The University of Georgia, USA
250. Mukai, Hitoshi
 National Institute for Environmental Studies, Japan
251. Murata, Akihiko
 JAMSTEC, Japan
252. Murayama, Shohei
 National Institute of Advanced Industrial Science and Technology (AIST), Japan
253. Murray, James W.
 University of Washington, USA
254. Murray-Tortarolo, Guillermo
 University of Exeter, United Kingdom
255. Mystakidis, Stefanos
 ETH Zurich, Switzerland
256. Na, Qiao
 Xishuangbanna Tropical Botanical Garden. Chinese Academy of Science, China
257. Nakamura, Takashi
 Japan Meteorological Agency, Japan
258. Nakaoka, Shin-ichiro
 National Institute for Environmental Studies, Japan
259. Nakicenovic, Nebojsa
 IIASA and Vienna Univ. of Technology, Austria
260. Nguyen Hoang, Thai Khang
 Institute of Oceanography, Vietnam
261. Nickless, Alecia
 Council for Scientific and Industrial Research, South Africa
262. Niu, Shuli
 Institute of Geographic Sciences and Natural Resources Research, Chinese Academy of Sciences, China
263. Niwa, Yosuke
 Meteorological Research Institute, Japan
264. Nomura, Shohei
 National Institute for environmental Studies (NIES), Japan
265. Oda, Tom
 CSU-NOAA, USA
266. Ojala, Anne
 University of Helsinki, Finland
267. Oncley, Steven
 NCAR/EOL, USA
268. Orr, James
 LSCE/IPSL, CEA-CNRS-UVSQ, France
269. Ouchi, Mai
 Nagoya University, Japan
270. Pajusalu, Liina
 Estonian Marine Institute, University of Tartu, Estonia
271. Pan, Gong
 University of Leicester, United Kingdom
272. Parazoo, Nicholas
 Jet Propulsion Laboratory, USA
273. Park, Geun Ha
 Korea Institute of Ocean Science & Technology (KIOST), South Korea
274. Park, Sung-Bin
 MPI-gBGC, South Korea
275. Patra, Prabir
 Research Institute for Global Change/JAMSTEC, Japan
276. Peng, Changhui
 University of Quebec at Montreal, Canada
277. Peng, Chuang
 University of Exeter, United Kingdom
278. Peters, Wouter
 Wageningen University, Netherlands
279. Peylin, Philippe
 LSCE, France
280. Pfeil, Benjamin
 University of Bergen, Norway
281. Piao, Shilong
 Peking University, China
282. Pickers, Penelope
 School of Environmental Sciences, University of East Anglia, United Kingdom
283. Piper, Stephen
 UCSD/Scripps Institution of Oceanography, USA
284. Post, Hanna
 Juelich Research Center GmbH, Germany
285. Prentice, Iain Colin
 Imperial College, United Kingdom
286. Qi, Ye
 Tsinghua University, China
287. Qian, Duo
 Beijing Forestry University, China
288. Qu, Bo
 Nantong University, China
289. Racape, Virginie
 LOCEAN-IPSL-UPMC, France
290. Rahman, Md. Mizanur
 SAARC Meteorological Research Centre (SMRC), Bangladesh
291. Ravi Kumar, Kunchala
 IITP, India
292. Raymond, Peter
 Yale FES, USA
293. Rayner, Peter
 The University of Melbourne, Australia
294. Regnier, Pierre
 Université Libre de Bruxelles, Belgium
295. Reichstein, Markus
 Max-Planck-Institute for Biogeochemistry, Germany
296. Resplandy, Laure
 LSCE-IPSL, France
297. Rodgers, Keith
 AOS Program, Princeton University, USA
298. Roedenbeck, Christian
 Max Planck Institute for Biogeochemistry Jena, Germany
299. Roy, Tilla
 L'Ocean, France
300. Rubino, Mauro
 CSIRO, Australia
301. Saitoh, Naoko
 Center for Environmental Remote Sensing, Chiba University, Japan
302. Sanchez, Maria Luisa
 LATUV-University of Valladolid, Spain
303. Sasai, Takahiro
 Nagoya Univ., Japan
304. Sasakawa, Motoki
 National Institute for Environmental Studies, Japan
305. Sasano, Daisuke
 Meteorological Research Institute, Japan
306. Sasse, Tristan
 University of New South Wales, Australia
307. Sawa, Yousuke
 Meteorological Research Institute, Japan
308. Schaefer, Doug
 Xishuangbanna Trop Bot Gdn, China
309. Scholze, Marko
 Lund University, Sweden
310. Schroder, Ivan
 Geoscience Australia, Australia
311. Schuster, Ute
 University of East Anglia, United Kingdom
312. Schwandner, Florian M
 Jet Propulsion Laboratory, USA
313. Schwinger, Joerg
 Geophysical Institute/University of Bergen, Norway
314. Sebastien, Biraud
 Lawrence Berkeley National Laboratory, USA

- 315. Séférian, Roland**
LSCE/IPSL, France
- 316. Seibt, Ulli**
UCLA, USA
- 317. Shchepashchenko, Dmitry**
IIASA, Austria
- 318. Shen, Chengde**
Guangzhou Institute of Geochemistry, Chinese Academy of Sciences, China
- 319. Shen, Jiaheng**
Institute of Geology and Geophysics, CAS, China
- 320. Sheng, Yao**
School of Mathematical Sciences, Beijing Normal University, China
- 321. Shi, Hao**
UTS, Australia
- 322. Shi, Yusheng**
Nagoya University, Japan
- 323. Shiga, Yoichi**
Stanford University, USA
- 324. Shim, Changsub**
Korea Environment Institute, South Korea
- 325. Shvidenko, Anatoly**
IIASA, Austria
- 326. Sistani, Karamat**
USDA-ARS, USA
- 327. Six, Katharina**
Max Planck Institute for Meteorology, Germany
- 328. Smirnov, Nikolay**
IGCE of Roshydromet and RAS, Russian Fed
- 329. Son, Yowhan**
Korea University, South Korea
- 330.**
- 331. Song, Zhaoyang**
Ocean University of China, China
- 332. Sperlich, Peter**
MPI-BGC, Germany
- 333. Stavert, Ann**
CSIRO, Australia
- 334. Steinkamp, Kay**
National Institute of Water and Atmospheric Research, New Zealand
- 335. Stephens, Britton**
National Center for Atmospheric Research, USA
- 336. Sugawara, Satoshi**
Miyagi University of Education, Japan
- 337. Sun, Jielun**
National Center for Atmospheric Research, USA
- 338. Sun, Xian**
Shanxi Province Climate Center, China
- 339. Suto, Hiroshi**
JAXA, Japan
- 340. Swathi, Pananjady**
CMMACS, India
- 341. Takakiyo, Nakazawa**
Tohoku University, Japan
- 342. Tao, Bo**
Auburn University, USA
- 343. Tarko, Alexander**
Computing Center Russian Academy of Sciences, Russian Fed
- 344. Tazu, Saeki**
National Institute for Environmental Studies, Japan
- 345. Telionis, Demetri**
Virginia Polytechnic Institute and State University, USA
- 346. Telszewski, Maciej**
International Ocean Carbon Coordination Project, Poland
- 347. Temme, Andries**
VU University, Netherlands
- 348. Teramoto, Munemasa**
National Institute for Environmental Studies, Japan
- 349. Terao, Yukio**
National Institute for Environmental Studies, Japan
- 350. Thompson, Rona**
NILU, Norway
- 351. Tian, Hanqin**
Auburn University, USA
- 352. Tian, Xiangjun**
Institute of Atmospheric Physics, Chinese Academy of Sciences, Beijing, China, China
- 353. Tiwari, Yogesh**
Indian Institute of Tropical Meteorology, India
- 354. Tjiputra, Jerry**
Uni Research, Bergen, Norway, Norway
- 355. Tohjima, Yasunori**
National Institute for Environmental Studies, Japan
- 356. Tomelleri, Enrico**
MPI, Germany
- 357. Totterdell, Ian**
Met Office, U.K., United Kingdom
- 358. Tsuboi, Kazuhiro**
Meteorological Research Institute, Japan
- 359. Tu, Jun**
Kennesaw State University, USA
- 360. Tum, Markus**
German Aerospace Center (DLR), Germany
- 361. Turk, Daniela**
Dalhousie University, Canada
- 362. Turnbull, Jocelyn**
GNS Science, New Zealand
- 363. Usatyuk, Vladimir**
Specialized Training–Research Center, Moscow State University, Russia, Russian Fed
- 364. Valsala, Vinu**
Indian Institute of Tropical Meteorology (IITM), India
- 365. van der Laan-Luijkx, Ingrid**
Wageningen University, Netherlands
- 366. van der Schoot, Marcel**
CSIRO, Australia
- 367. Vardag, Sanam Noreen**
Institute of Environmental Physics, Germany
- 368. Velasco, Erik**
Singapore-MIT Alliance for Research and Technology, Singapore
- 369. Vesala, Timo**
University of Helsinki, Finland
- 370. Vogel, Felix R.**
LSCE, France
- 371. Wan, Liyang**
Ministry of Education Key Laboratory for Earth System Modeling, and Center for Earth System Science, Tsinghua University, Beijing, China, China
- 372. Wang, Chongchen**
bucea, China
- 373. Wang, Haikun**
Nanjing University, China
- 374. Wang, Han**
Macquarie University, Australia
- 375. Wang, Hengmao**
International Institute for Earth System Science, Nanjing University, China
- 376. Wang, Jinfang**
Beijing Ecotek Company Limited, China
- 377. Wang, Jun**
LASG, China
- 378. Wang, Lei**
Tianjin University of Science & Technology, China
- 379. Wang, Liang**
Ocean University of China, China
- 380. Wang, Shaoqiang**
Institute of Geographic Sciences and Natural Resources Research, China
- 381. Wang, Shirly**
CAS
- 382. Wang, Wenfeng**
Chinese Academy of Sciences, China
- 383. Wang, Xiujun**
University of Maryland, USA
- 384. Wang, Xufeng**
Cold and Arid Regions Environmental and Engineering Research Institute, Chinese Academy of Sciences, China
- 385. Wang, Xuhui**
Peking University, China
- 386. Wang, Yingping**
CSIRO, Australia
- 387. Wang, Yun**
School of Mathematical Sciences, Beijing Normal University, China
- 388. Wang, Yuting**
Institute of Environmental Physics, Germany
- 389. Wang, Yuying**
Center for Agricultural Resources Research, Institute of Genetics and Developmental Biology, Chinese Academy of Sciences, China
- 390. Wang, Zhaohui Aleck**
Woods Hole Oceanographic Institution, USA
- 391. Wanninkhof, Richard**
NOAA/AOML, USA
- 392. Watson, Andrew**
University of East Anglia, United Kingdom
- 393. Welp, Lisa**
Scripps Institution of Oceanography, UCSD, USA
- 394. Wilson, Philip**

- University of East Anglia, United Kingdom
395. Wiltshire, Andrew
Met Office Hadley Centre, United Kingdom
396. Wong, Kam Weng (Clare)
Jet Propulsion Laboratory, USA
397. Wu, Chaoyang
University of Toronto, Canada
398. Wu, Fuzhong
Institute of Ecology & Forestry, Sichuan Agricultural University, China
399. Wu, Haibin
Institute of Geology and Geophysics, Chinese Academy of Sciences, China
400. Wu, You
University of Maryland, China
401. Wu, You
Nanjing University of Information Science & Technology, China
402. Xi, Fengming
Institute of Applied Ecology(IAE),CAS, China
403. Xia, Xueqi
China University of Geosciences, Beijing, China
404.
405. Xie, Zhenghui
LASG/IAP, China
406. Xing, Pan
East China university of science and technology, China
407. Xiong, Jun
ORAU, USA
408. Xiong, Xiaozhen
NOAA/NESDIS/STAR, USA
409. Xu, Bin
NMIC, China
410. Xu, Minggang
Soil and Fertilizer Institute, Chinese Academy of Agricultural Sciences, China
411. Xu, Xiaomei
University of California, Irvine, USA
412. Xue, Liang
First Institute of Oceanography, SOA, China
413. Xue, Ming
Ocean University of China, China
414. Yadav, Vineet
Carnegie Institution for Science, Department of Global Ecology, USA
415. Yan, Yuan
University of Antwerp, Belgium
416. Yang, Gang
Northwest A&F University, China
417. Yang, Jiameng
Nanjing University, China
418. Yaremchuk, Alexey
Andreyev Acoustics Institute, Russian Fed
419. Yasunaka, Sayaka
National Institute for Environmental Studies, Japan
420. Ye, Hui
Chinese academic of science, China
421. Yi, Weixi
Guangzhou Institute of Geochemistry, Chinese Academy of Sciences, China
422. Yokota, Tatsuya
National Institute for Environmental Studies, Japan
423. Yoshida, Yukio
National Institute for Environmental Studies, Japan
424. Yoshikawa, Hisayuki
Hokkaido University, Japan
425. Yu, Yanyan
Institute of Geology and Geophysics, Chinese Academy of Science, China
426. Yu, Yongqiang
IAP, CAS, China
427. Yu, Zicheng
Lehigh University, USA
428. Yuan, Zhuang
The National Meteorological Information Center, China
429. Zamelczyk, Katarzyna
University of Tromsø, Department of Geology, Norway
430. Zeng, Michael
Ecotech, Australia
431. Zeng, Ning
University of Maryland, USA
432. Zha, Tianshan
Beijing Forestry University, China
433. Zha, Tonggang
Beijing Forestry University, China
434. Zhai, Weidong
National Marine Environmental Monitoring Center, China
435. Zhang, Chi
Xinjiang Institute of Ecology and Geography, CAS, China
436. Zhang, Fangmin
University of Toronto, Canada
437. Zhang, Haiyun
China University of petroleum, China
438. Zhang, Huifang
Institute of Geographic Sciences and Natural Resources Research, CAS, China
439. Zhang, Meigen
Institute of Atmospheric Physics, China
440. Zhang, Qian
Beijing Normal University, China
441. Zhang, Qiang
Institute of Geographic Sciences and Natural Resources Research, CAS, China
442. Zhang, Qingyu
Institute of Geographic Sciences and Natural Resources Research, CAS, China
443. Zhang, Tinglong
Northwest A&F University, China
444. Zhang, Wenjin
Shanxi Province Climate Center, China
445. Zhang, Wenxin
Lund University, Sweden
446. Zhang, Xia
Institute of Atmospheric Physics, Chinese Academy of Science, China
447. Zhang, Xiaochun
Research Center for Eco-Environmental Sciences, Chinese Academy of Sciences, China
448. Zhang, Yanxia
Nanjing University, China
449. Zhang, Yao
Northwest A&F University, USA
450. Zhao, Deai
Institute of geology and geophysics ,CAS, China
451. Zhao, Dongliang
Ocean university of china, China
452. Zhao, Fang
University of Maryland, USA
453. Zhao, Huade
National Marine Environmental Monitoring Center, China, China
454. Zhao, Meifang
Centural South University of Forestry and Technology, China
455. Zhao, Yonghua
Cold and Arid Regions Environment and Engineering Research Institute,CAS, China
456. Zhao, Yumei
National Ocean Technology Center, China
457. Zhen, Xiaojie
北京天诺基业科技有限公司, China
458. Zheng, Heng
Beijing Normal University, China
459. Zheng, Xiaogu
College of global change and earth system science, Beijing Normal University, China
460. Zhengjia, Liu
Institute of Geographic Sciences and Natural Resources Research, Chinese Academy of Sciences, China
461. Zhou, Cong
East China Normal University, China
462. Zhou, Jie
Beijing Forest University, China
463. Zhou, Liping
Peking University, China
464. Zhou, Tao
Beijing Normal University, China
465. Zhu, Chunmao
Hokkaido University, Japan
466. Zhu, Gaofeng
Lanzhou University, China
467. Zhu, Qiuhan
Northwest A&F University, China
468. Zhu, Zhiliang
USGS, USA
469. Zhuravlev, Ruslan
Central Aerological Observatory, Russian Fed
470. Ziehn, Tilo
CSIRO, Australia
471. Yao, Yongjun
Beijing Truvel Instruments, Inc., China
472. Liu, Lingli
Institute Of Botany, CAS



















